

## Specifications:

- Metal construction for durability and reliability
- Pressure balancing single handle diverting and volume control
- Max-temperature limit stop for added safety
- Integral stop check valves for easy maintenance
- Requires the fluid F1002B or F1042B pressure balancing valve, (sold separately and available in solder, PEX and PEX-W.)

## Components:

F1001TMB .....	Sleeve Tube and Cap
FP6028341MB .....	Wisdom Handle
FP6001035MB-1PB.....	Round Cover Plate
FP6098035LMB .....	7.5" Curved Tub Spout
FP6016008MB .....	8" Shower Arm
FP6000350MB .....	6" Round Showerhead

## Features:

 Requires 2-way diverting F1002B or F1042B valve

 Integral Stops  Bubble Level

 Slip Fit Connection

## Wisdom Curved Tub Spout & 6" Showerhead Trim Kit

F284109TMB



Matte Black (MB)

## Technical Drawing

F284109TMB

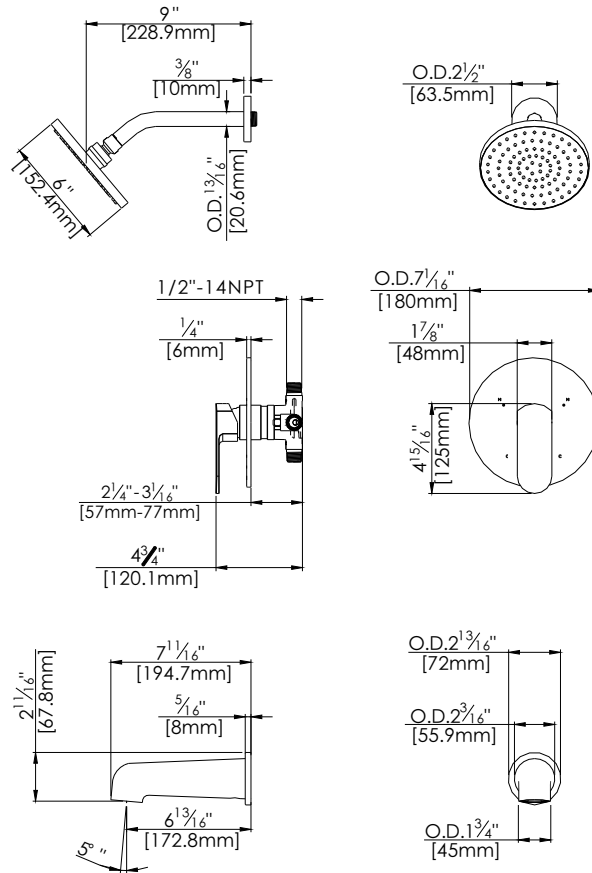

## Warranty:

Limited Lifetime Faucet Warranty  
against material and manufacturing  
defects for residential use.

2 Year Limited Warranty on all industrial,  
commercial and business applications.

## Codes and Standards:

ANSI/ASME A112.18.1

CSA B125.1

IAPMO / cUPC Listed

ADA Compliant

## Flow Rate:

Showerhead 1.8 gpm @ 60 psig

Tub Spout 4.5 gpm @ 60 psig

Low Flow Alternative: Showerhead  
@ 1.5 gpm: **F284109TMB-15**