

## 26" Switch Retrofit Slide Bar (Round Trim) with 8" Shower Arm

F9308

### Specifications:

- **Stainless Steel Construction**
- **Designed for flexible installation**—it can either retrofit an existing system by replacing a standard shower arm or be integrated into a new installation complete with rough-in valve (all components and valves are sold separately)
- **Two mounting options:** drill into shower wall or drill-free using only the supplied waterproof adhesive
- **Multi-function:** Switch Systems can integrate a showerhead, hand shower, and even a tub spout—using only a non-diverting rough-in valve
- **8" Swivelling Switch Shower Arm** for adjustable positioning
- **Built in Check Valve** prevents backflow
- **Reversible Hose Elbow** installs left or right
- **Water Inlet** is located at the top installation post
- **Optional 65 mm escutcheons** available for larger wall openings (sold separately)

### Components:

FP933000	26" Main Slide Bar (Round Trim)
FP900208	8" Shower Arm with 2" Riser



Polished Chrome (CP), Brushed Nickel (BN), and Matte Black (MB)

## Technical Drawing

F9308

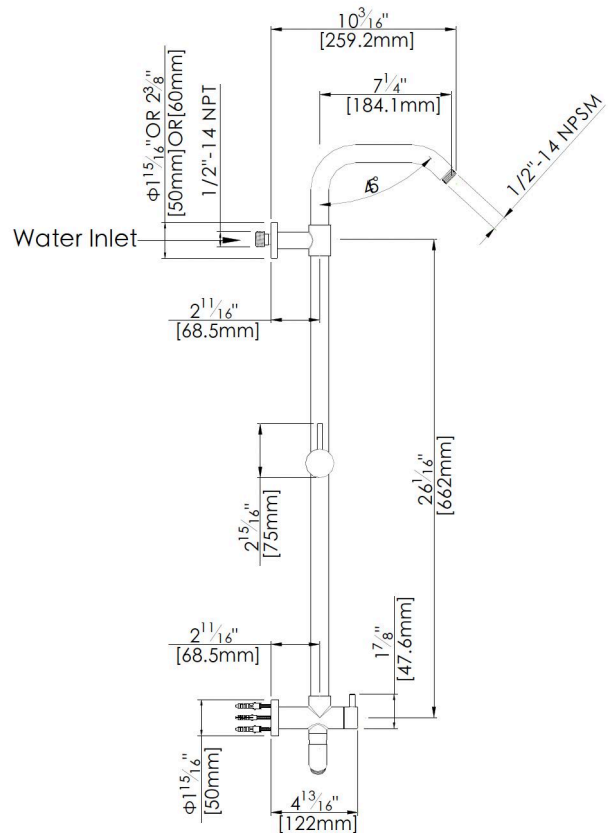
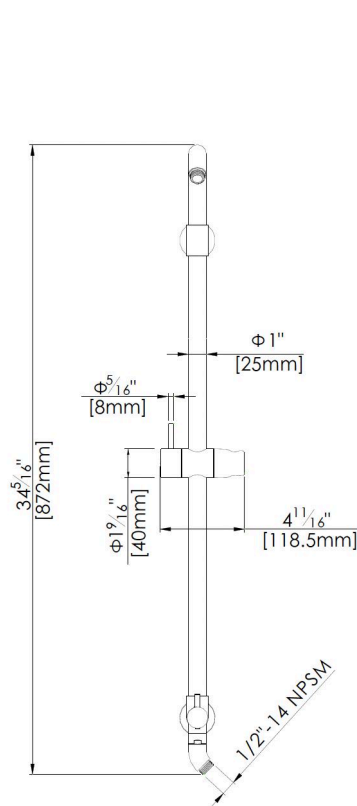

## Warranty

Limited Lifetime Faucet Warranty against material and manufacturing defects for residential use.

2 Year Limited Warranty on all industrial, commercial and business applications.

## Codes and Standards:

ANSI/ASME A112.18.1

CSA B125.1

IAPMO / cUPC Listed

ADA Compliant

## Flow Rate:

Will be determined by the Showerhead and Hand Shower chosen