

Specifications:

- **Stainless Steel Construction**
- **Designed to replace a standard wall-mounted showerhead and arm with a slide bar system** featuring a built-in water outlet and diverter to direct flow to either the showerhead or hand shower
- **Works with the existing rough-in valve**—no need to alter plumbing behind the wall or modify the shower wall
- **Two mounting options:** drill into shower wall or drill-free using only the supplied waterproof adhesive
- **3-Function Hand Shower**
- **Adjustable Slide Bar** allows you to change hand shower height
- **8" Swivelling Switch Shower Arm** for adjustable positioning
- **Reversible Hose Elbow** installs left or right
- **Water Inlet** is located at the top installation post
- **Built in Check Valve** prevents backflow
- **Optional 65 mm escutcheons** available for larger wall openings (sold separately)

Components:

FP933002	18" Main Slide Bar (Round Trim)
FP900208	8" Shower Arm with 2" Riser
FP40120	3-Function Round Hand Shower *
FP6000350	6" Round Shower Head
FP6001006	60" Shower Hose *

* **Matte Black Specific Components**
FP6001007MB Hose | FP40130MB Hand Shower

Switch Retrofit Shower & Hand Shower Trim Kit

F9508-001-18



Polished Chrome (CP), Brushed Nickel (BN), and Matte Black (MB)

F9508-001-18

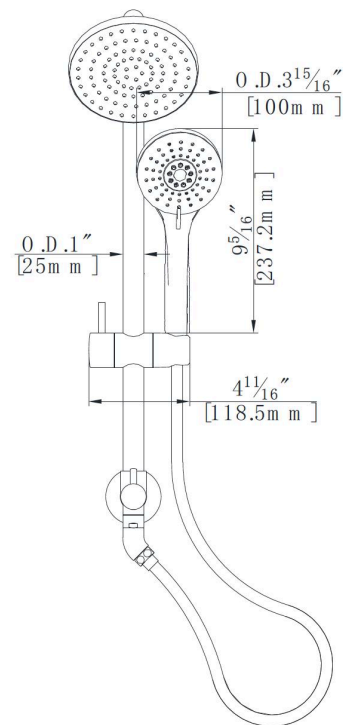

WEBSITE