

Specifications:

- Heavy brass construction
- German made Fluhs ceramic cartridge ensures lifelong trouble free service
- Dual handle operation allows both volume and temperature control
- Flow restricted to 1.2 gpm, (4.6 lpm) at 60 psi
- fluid Eco-Care swivel aerator prevents splash back by allowing adjustment to the direction of water flow
- Stainless steel flexible connections for 6" to 8" wide installation
- Dual supply inlet connections -3/8" comp. & 1/2" thread
- 1 - 1/4" or 1-1/2" faucet hole size for drilling is recommended
- Includes the fluid Quick Clean waste pop-up drain, with removable basket
- ADA Compliant



FA726MB



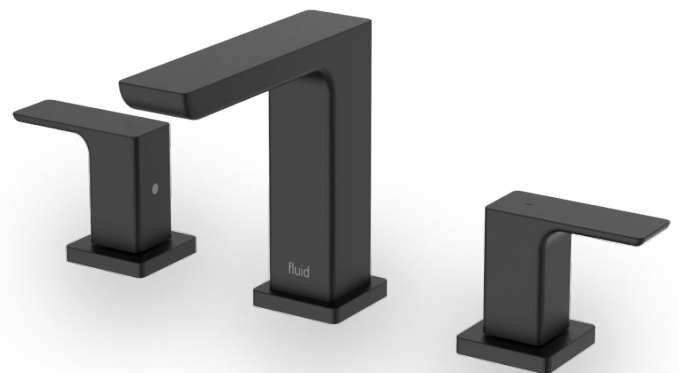

Quick Clean Pop-Up with Overflow

Quad Dual Handle Bathroom faucet with Quick Clean Pop-Up

F16006MB



Features:

-  Removable Quick Clean Basket
-  Precision Ceramic Disc Cartridge
-  Brass Construction
-  Swivel Aerator to direct water stream

Matte Black (MB)

Technical Drawing

F16006MB

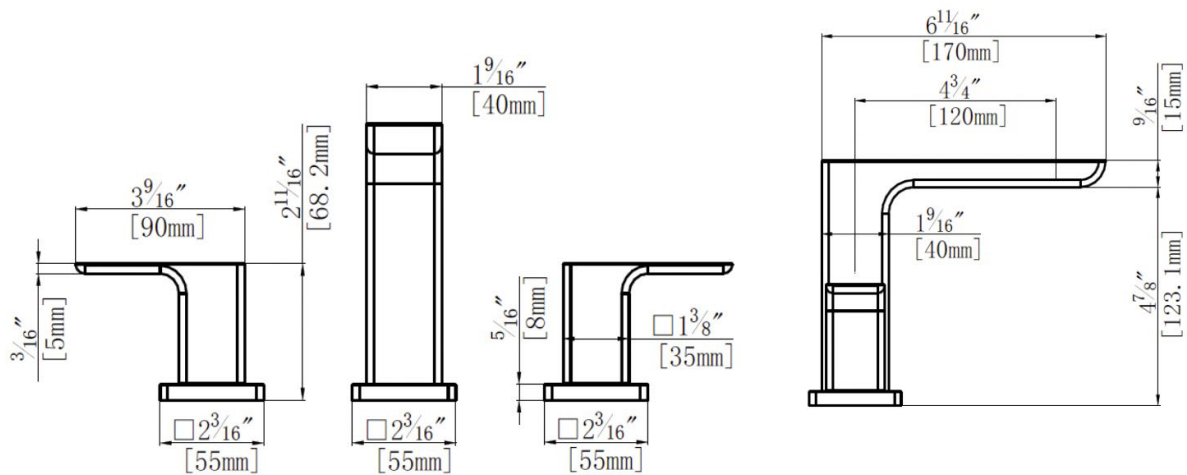

Warranty:

Limited Lifetime Faucet Warranty
against material and manufacturing
defects for residential use.
2 Year Limited Warranty on all industrial,
commercial and business applications.

Codes & Standards:

ANSI/ASME A112.18.1
CSA B125.1
NSF/ANSI/CAN 61: Q < 1
NSF / ANSI / CAN372
IAPMO / cUPC Listed
EPA Watersense Listed
ADA Compliant

Flow Rate:

1.2 gpm (4.6 lpm) at 60 psi

Low Flow Alternative
@1.0 gpm (3.6 lpm) **F16001-10**