

Specifications:

- Metal construction
- Pressure balancing with volume control
- Maximum temperature limit stop for added safety
- Integral stop check valves for easy maintenance
- Requires the fluid F1001B or F1021B pressure balancing valve, (sold separately and available in solder, PEX and PEX-W.)

Components:

F1001T	Sleeve tube and cap
FP6016041	Quad / Jovian Handle
FP6001033-1PB	Square Cover Plate
FP20100	5-Function Showerhead
FP6027008	8" Shower Arm

Jovian 5-Function Shower Head Trim Kit

F211006T-Q



Features:

 Requires non-diverting F1001B or F1021B valve

 Integral Stops

 Bubble Level

Polished Chrome (CP) and Brushed Nickel (BN)

Technical Drawing

F211006T-Q

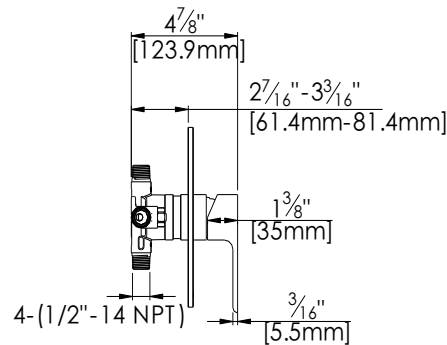
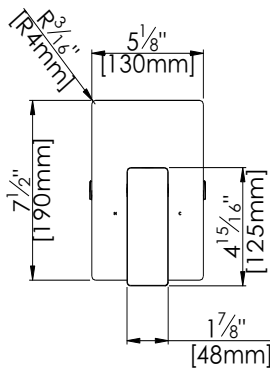
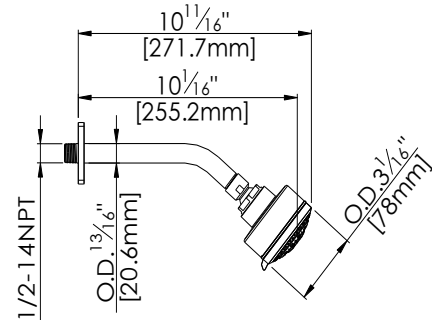
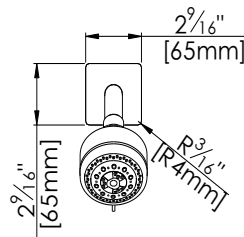

Warranty:

Limited Lifetime Faucet Warranty
against material and manufacturing
defects for residential use.
2 Year Limited Warranty on all industrial,
commercial and business applications.

Codes and Standards:

ANSI/ASME A112.18.1
CSA B125.1
IAPMO / cUPC Listed
ADA Compliant

Flow Rate:

Showerhead 1.8 gpm @ 60 psig

Low Flow Alternative: Showerhead
@ 1.5 gpm: **F211006T-Q-15**