

Specifications:

- Metal construction for durability and reliability
- Pressure balancing volume control
- Max-temperature limit stop for added safety
- Integral stop check valves for easy maintenance
- Requires the fluid F1001B or F1021B pressure balancing valve, (sold separately and available in solder, PEX and PEX-W.)

Components:

F1001T	Cartridge Sleeve
FP6028341	Wisdom Handle
FP6001035-1PB	Round Cover Plate
FP40120	3-Function Hand Shower*
FA802	Slide Bar with Integral Outlet
FP6001006	60" Shower Hose*

* Matte black uses an FP6001007MB Shower Hose & FP40130MB 3-Function Hand Shower

Features:

 Requires non-diverting F1001B or F1021B valve

 Integral Stops  Bubble Level

 Speed Connect

Wisdom 3-Function Hand Shower Trim Kit with FA802 Slide Bar

F281019T

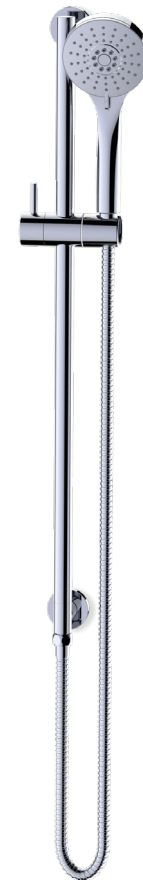

Polished Chrome (CP), Brushed Nickel (BN) and Matte Black (MB)

Technical Drawing

F281019T

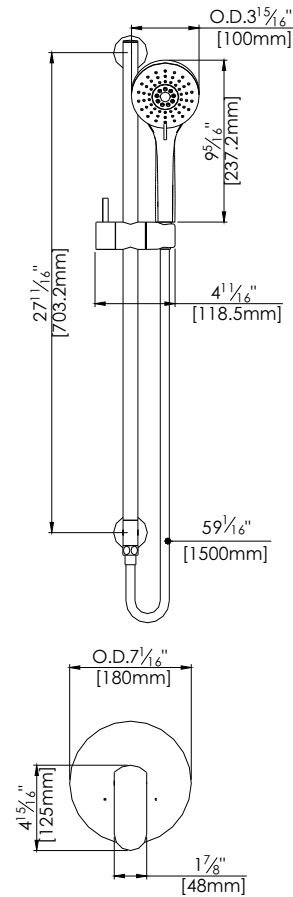
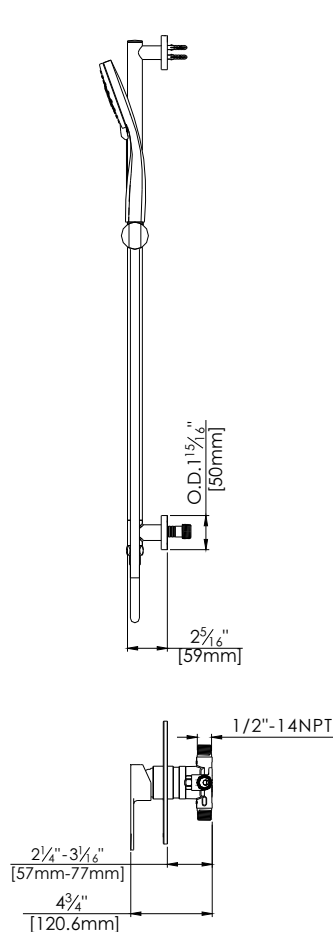

Warranty:

Limited Lifetime Faucet Warranty against material and manufacturing defects for residential use.

2 Year Limited Warranty on all industrial, commercial and business applications.

Codes and Standards:

ANSI/ASME A112.18.1

CSA B125.1

IAPMO / cUPC Listed

EPA Watersense Listed (excluding MB Version)

ADA Compliant

Flow Rate:

Hand Shower 1.8 gpm @ 60 psig

Low Flow Alternative: Hand Shower @ 1.5 gpm: **F281019T-15**