

## Specifications:

- ➔ Metal construction
- ➔ Pressure balancing volume control with 3-way, two handle diverting
- ➔ Maximum temperature limit stop for added safety
- ➔ Integral stop check valves for easy maintenance
- ➔ Requires the fluid F1003B or F1023B pressure balancing valve, (sold separately and available with shut off or \*\*sharing in solder, PEX and PEX-W.)

## Components:

F1001T .....	Sleeve Tube and Cap
FP6016041 .....	Quad Handle
FP801013 .....	Diverter Sleeve
FP605752 .....	Diverter Handle
FP6001143-3PB .....	Square Cover Plate
FP6021308 .....	3" Ceiling Shower Arm
FP6001150 .....	8" Square Rain Showerhead
FP6027008 .....	8" Shower Arm
FP6000150 .....	6" Showerhead
FP6001006 .....	60" Shower Hose*
FA803 .....	Slide Bar With Integral Outlet
FP40120 .....	3-Function Hand Shower*

\*\*sharing available where allowed by code

Kit with Alternate Handle: **F163036T-ABS-AS**



## Features:

 Requires 3-way diverting F1003B or F1023B valve

 Integral Stops  Bubble Level

 Speed Connect

## Quad Double Showerhead and 3-Function Hand Shower Trim Kit

F163036T-ABS



\* Matte Black features: FP6001007MB Hose, FP40130MB Hand Shower

Polished Chrome (CP), Brushed Nickel (BN) and Matte Black (MB)

## Technical Drawing

F163036T

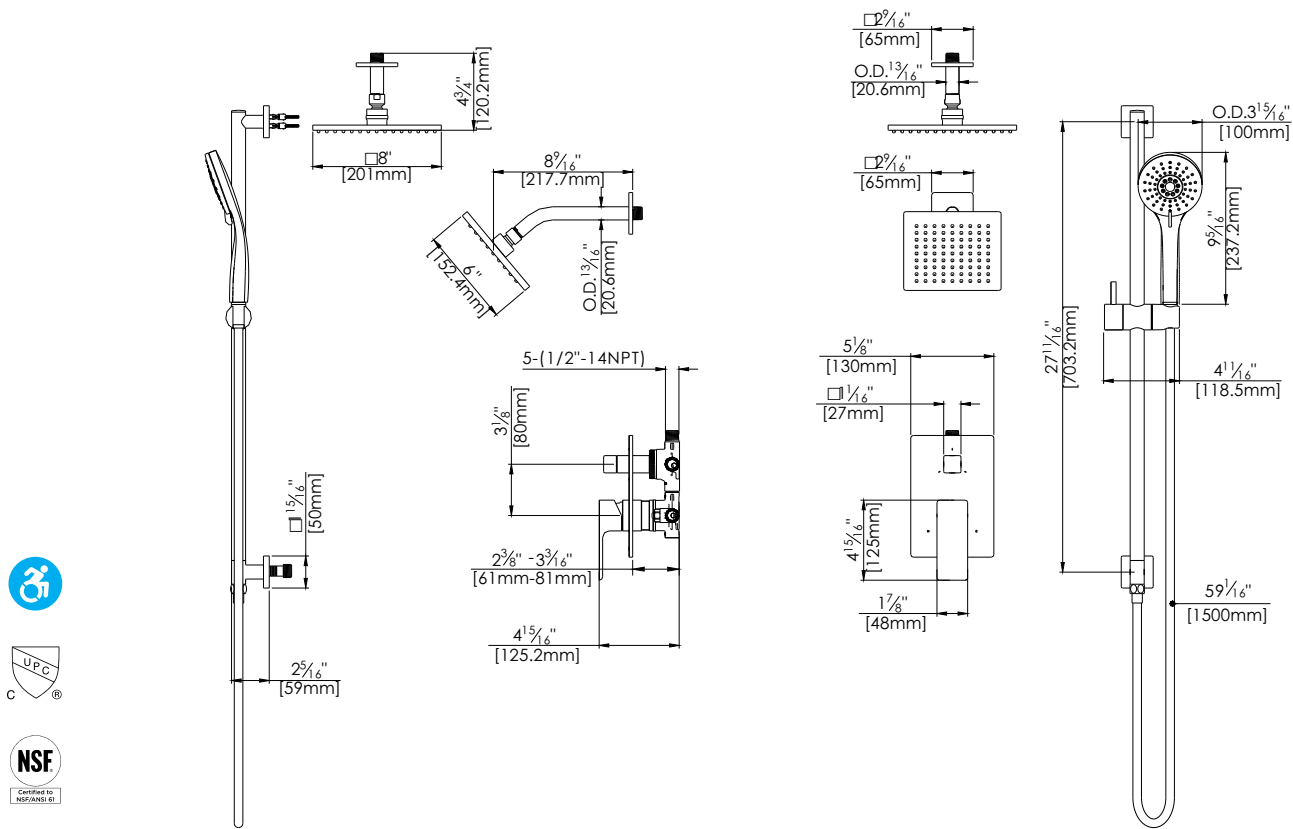

## Warranty:

Limited Lifetime Faucet Warranty  
against material and manufacturing  
defects for residential use.

2 Year Limited Warranty on all industrial,  
commercial and business applications.

## Codes and Standards:

ANSI/ASME A112.18.1

CSA B125.1

IAPMO / cUPC Listed

ADA Compliant

## Flow Rate:

Showerheads 1.8 gpm @ 60 psig

Hand Shower 1.8 gpm @ 60 psig

Low Flow Alternative: Hand Shower &  
Showerhead @ 1.5 gpm: **F163036T-  
ABS-15**