

Specifications:

- ➔ Metal construction
- ➔ Pressure balancing with volume control
- ➔ Maximum temperature limit stop for added safety
- ➔ Integral stop check valves for easy maintenance
- ➔ Requires the fluid F1001B or F1021B pressure balancing valve, (sold separately and available in solder, PEX and PEX-W.)

Components:

F1001T	Sleeve tube and cap
FP6016041	Quad Handle
FP6001033-1PB	Square Cover Plate
FP20100	5-Function Showerhead
FP6027008	8" Shower Arm

Quad 5-Function Shower Head Trim Kit

F161006T



Features:

 Requires non-diverting F1001B or F1021B valve

 Integral Stops

 Bubble Level

 Speed Connect

Polished Chrome (CP), Brushed Nickel (BN) & Matte Black (MB)

Technical Drawing

F161006T

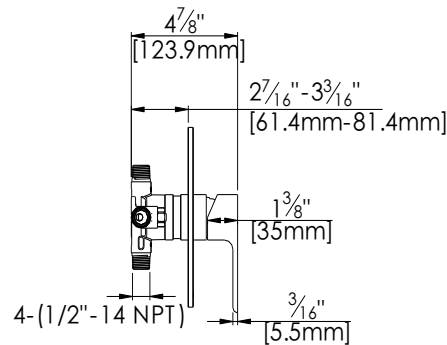
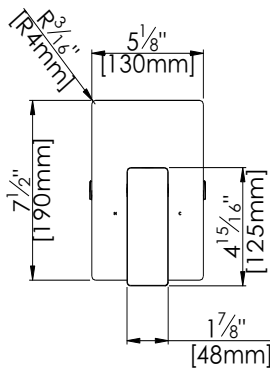
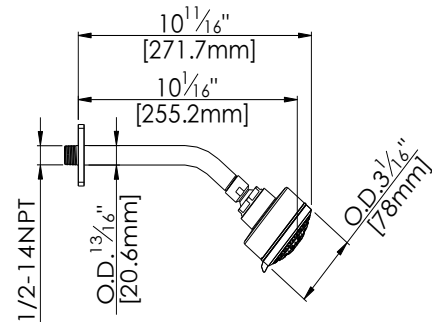
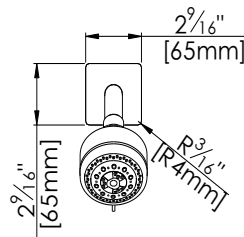

Warranty:

Limited Lifetime Faucet Warranty
against material and manufacturing
defects for residential use.
2 Year Limited Warranty on all industrial,
commercial and business applications.

Codes and Standards:

ANSI/ASME A112.18.1
CSA B125.1
IAPMO / cUPC Listed
ADA Compliant

Flow Rate:

Showerhead 1.8 gpm @ 60 psig

Low Flow Alternative: Showerhead
@ 1.5 gpm: **F161006T-15**