

Specifications:

- Metal construction for durability and reliability
- Pressure balancing volume control with 2-way single handle diverting
- Max-temperature limit stop for added safety
- Integral stop check valves for easy maintenance
- Requires the fluid F1002B or F1042B pressure balancing valve, (sold separately and available in solder, PEX and PEX-W.)

Components:

| | |
|---------------------|---------------------|
| F1001T | Sleeve tube and cap |
| FP6018041 | Utopia Handle |
| FP6001035-2PS | Round Cover Plate |
| FP6016008 | 8" Shower Arm |
| FP6000350 | 6" Showerhead |
| FP6057034 | Pipe Tub Spout |

Utopia Tub & 6" Shower Trim Kit (Single Handle)

F184102T



Features:



Requires 2-way diverting F1002B or F1042B valve



Integral Stops



Bubble Level



Speed Connect

Polished Chrome (CP) and Brushed Nickel (BN)

Technical Drawing

F184102T

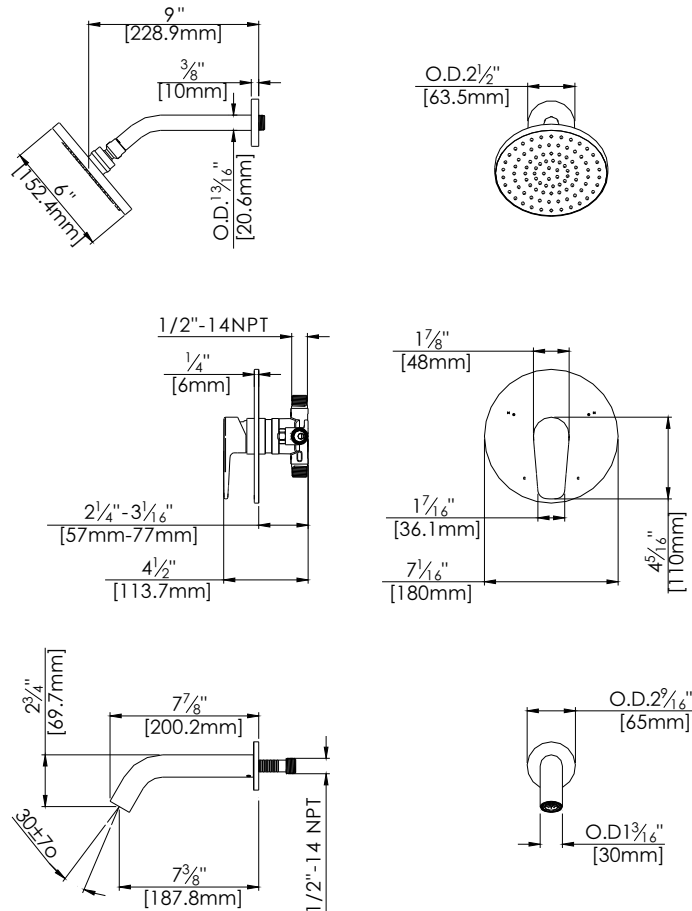

Warranty:

Limited Lifetime Faucet Warranty
against material and manufacturing
defects for residential use.

2 Year Limited Warranty on all industrial,
commercial and business applications.

Codes and Standards:

ANSI/ASME A112.18.1

CSA B125.1

IAPMO / cUPC Listed

ADA Compliant

Flow Rate:

Showerhead 1.8 gpm @ 60 psig

Tub Spout 4.5 gpm @ 60 psig

Low Flow Alternative: Showerhead
@ 1.5 gpm: **F184108T-15**