

Citi Hand Shower on FA101 Slide Bar Trim Kit

F241238T

Specifications:

- Metal construction for durability and reliability
- Pressure balancing volume control
- Max-temperature limit stop for added safety
- Integral stop check valves for easy maintenance
- Valve and trim packages are sold separately
- Requires the fluid F1001B or F1021B pressure balancing valve, (sold separately and available in solder, PEX and PEX-W.)

Components:

F1001T	Cartridge Sleeve
FP6024041	Blade Handle
FP6001035-1PB	Round Cover Plate
FP40120	3-Function Hand Shower
FA101	Slide Bar
FP6082048	Wall Outlet
FP6001006	60" Shower Hose
FP6098034L	Curved Diverting Tub Spout

Features:

 Requires non-diverting F1001B or F1021B valve

 Integral Stops

 Bubble Level



Polished Chrome (CP), Brushed Nickel (BN)

Technical Drawing

F241238T

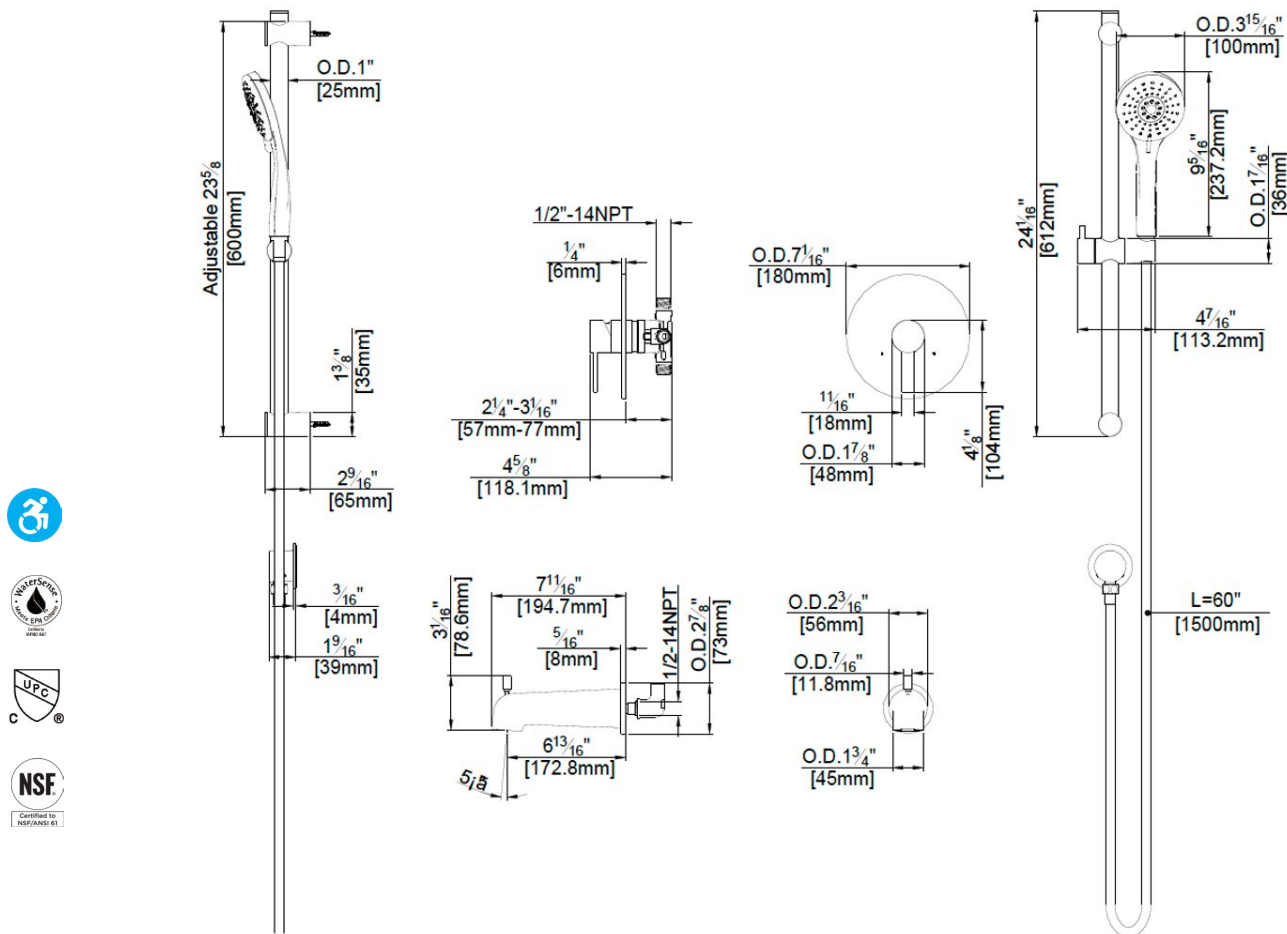

Warranty:

Limited Lifetime Faucet Warranty against material and manufacturing defects for residential use.

2 Year Limited Warranty on all industrial, commercial and business applications.

Codes and Standards:

ANSI/ASME A112.18.1

CSA B125.1

IAPMO / cUPC Listed

Flow Rate:

Hand Shower 1.8 gpm @ 60 psig

Low Flow Alternative: Hand Shower @ 1.5 gpm: **F241238T-15**