

## Specifications:

- Metal construction
- Features a round cover plate and the Yaletown series handle
- Dual handle operation; larger series handle controls temperature and volume; smaller handle diverts water
- Requires the fluid 3-Way diverting, pressure balancing rough-in valve F1023B or F1003B
- Valve and trim packages are sold separately

## Codes & Standards:

- ANSI/ASME A112.18.1
- CSA B125.1
- ADA, (with optional diverter handle\*)
- IAPMO/cUPC

## Warranty:

Limited Lifetime Faucet Warranty against material and manufacturing defects for residential use.

2 Year Limited Warranty on all industrial, commercial and business applications.

## Includes components:

- F1001T Sleeve Tube and Cap
- FP6001142-3PB Round Cover Plate
- FP6019041 Yaletown Handle
- FP605652 Round Diverter Handle
- FP801013 Diverter Sleeve Tube

\*Valve Trim kit with alternate ADA Handle:  
**FP6019243-3PB-AR**



## Round Trim kit for Pressure Balancing F1023B Valve

FP6019243-3PB



Polished Chrome (CP), Brushed Nickel (BN) & Matte Black (MB)

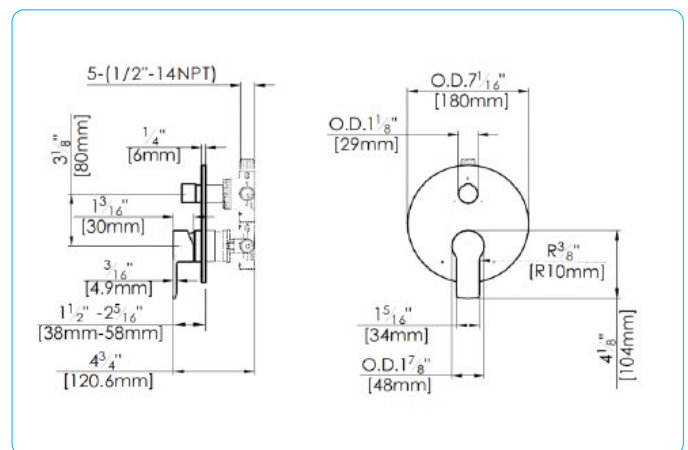

FP6019243-3PB March 2025