

Citi 6" Shower Head Only Trim Kit

F241003T

Specifications:

- ➔ Metal construction for durability and reliability
- ➔ Pressure balancing volume control
- ➔ Maximum temperature limit stop for added safety
- ➔ Integral stop check valves for easy maintenance
- ➔ Requires the fluid F1001B or F1021B pressure balancing valve, (sold separately and available in solder, PEX and PEX-W.)
- ➔ ADA compliant

Components:

F1001T	Sleeve Tube and Cap
FP6024041	Blade Handle
FP6001035-1PB	Round Cover Plate
FP6000350	6" Shower Head
FP6016008	8" Shower Arm



Features:

 Requires non-diverting F1001B or F1021B valve

 Integral Stops

 Bubble Level

 ADA

Polished Chrome (CP), Brushed Nickel (BN) and Matte Black (MB)

Technical Drawing

F241003T

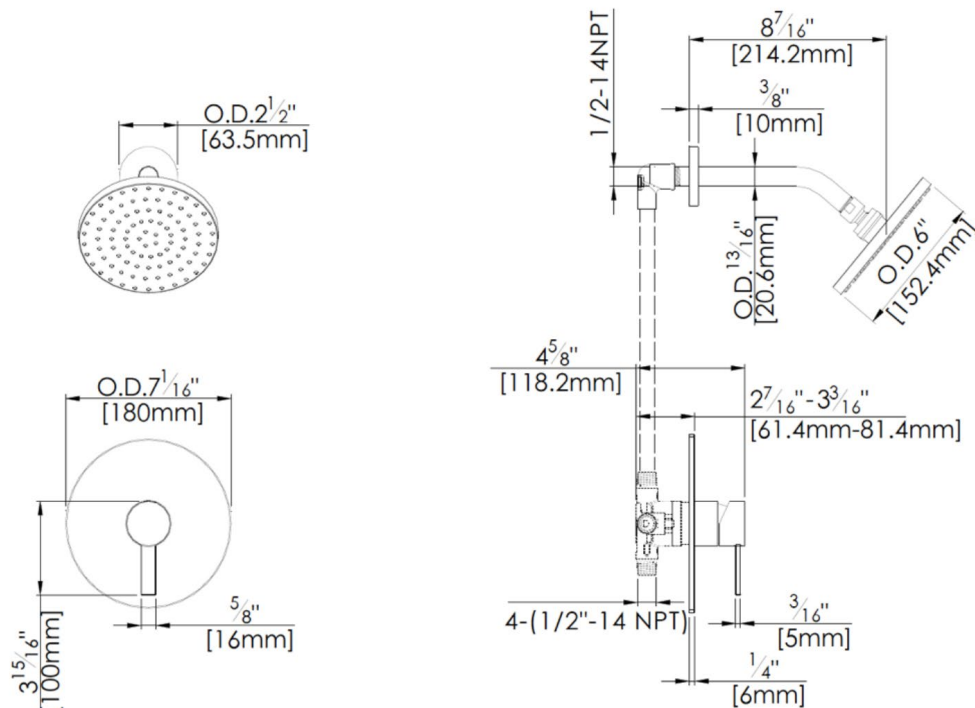

Codes and Standards: ANSI/ASME A112.18.1, CSA B125.1, IAPMO / cUPC Listed

Warranty:

Limited Lifetime Faucet Warranty against material and manufacturing defects for residential use.

2 Year Limited Warranty on all industrial, commercial and business applications.

Kit Variations:

Kit with square style cover plate & diverter handle: [F241003T-S](#)

Flow Rate:

Shower Head 1.8 gpm @ 60 psig

Low Flow Alternative: Shower Head @ 1.5 gpm: [F241003T-15](#)