

fluidTM

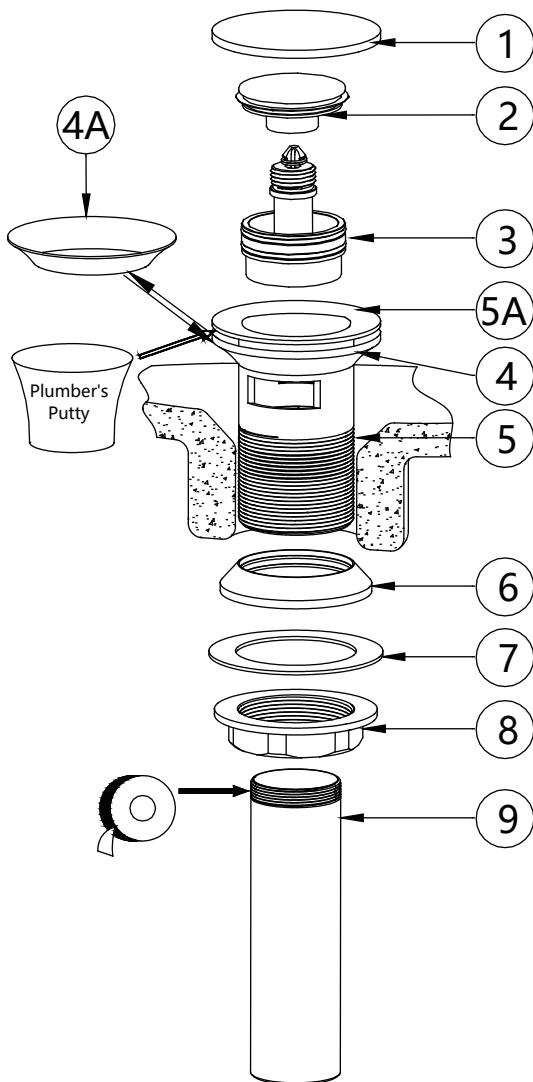

Push Type Easy Clean Drain Installation Instructions



Model #FA726

1. Remove plastic cover (#1).
2. Unscrew tail pipe (#9) from drain body (#5).
3. Remove locknut (#8), friction washer (#7) and black rubber gasket (#6) from drain body (#5).
4. With silicon or rubber gasket in place, insert drain body (#5) through drain hole from above. (Choose #4 or #4A depending on the slope of drain hole). Ensure silicon or rubber gasket, (#4 or #4A), securely seats inside the drain hole.
NOTE: The silicon or rubber basket (#4 or #4A) will work in the majority of installations. However, if there is a large slope or an uneven drain surface it is recommended that the installer should instead run a bead of plumber's putty below the flange (#5A) to achieve a water tight seal.
5. Re-install black rubber gasket (#6) with wide side facing down, friction washer (#7) and locknut (#8) in the order shown from under the sink.
6. Tighten locknut (#8) until black rubber washer (#6) securely seats inside drain hole. Tighten locknut (#8) with a wrench.
7. Wrap threads of tail pipe (#9) with Teflon tape, then screw tail pipe (#9) into drain body (#5).

Operation Instructions

- Push to raise stopper(#2) to open the drain.
- Push to lower stopper(#2) to close the drain.

Maintenance Instructions

The easy clean basket (#3) feature of this drain ensures that dirt and hair are trapped in the removeable basket, preventing clogs further down the drain line. Frequent cleaning of the basket (#3) will keep the drain opening clear and ensure a longer service life for this product. To clean basket:

1. Pull stopper (#2) straight up to remove basket (#3).
2. Remove any dirt or hair that has accumulated in basket (#3).
3. Rinse basket under clean water and replace basket (#3).
4. Replace basket (#3) along with stopper (#2) into the drain body (#5).

Need Help?

For additional assistance
Toll Free: 1 800 460 7019
Fax: 1 604 430 5050