

Specifications:

- Square extension diverter handle for fluid pressure balancing valve trims
- Replaces the standard FP605752MB diverter handle
- Allows wrist activation of fluid 2-way and 3-way shower valves
- Suitable for ADA or any application where easier turning is desired

Flow Rate

- 1.8 gpm @ 60 psig

Codes & Standards:

- ADA

Warranty:

Limited Lifetime Faucet Warranty against material and manufacturing defects for residential use.

2 Year Limited Warranty on all industrial, commercial and business applications.

fluid Square ADA Pressure Balancing Valve Diverter Handle

FP605753MB



Features:

ABS Manufactured out of ABS

Matte Black (MB)

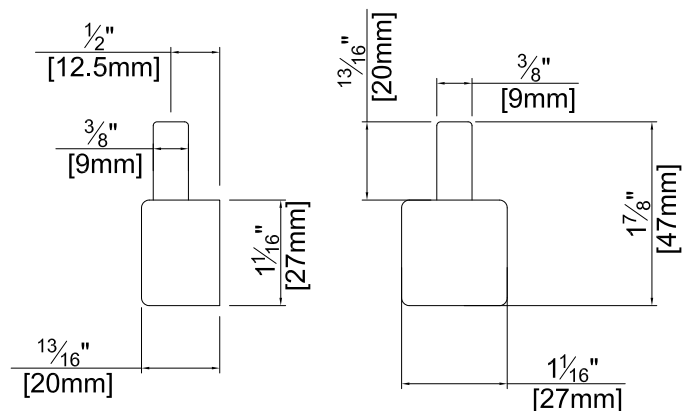

FP605753MB August 2024