

fluid



Duo Two Piece Suite

Vitreous China Single Flush High Efficiency (HET) Easy Height Elongated Bowl and Tank with Side Lever Handle

Siphonic Bowl #301502W

LH Lever Tank #301548W

RH Lever Tank #301548W-R

1.28 gpf (4.8 lpf)

PLUMBER'S INSTALLATION INSTRUCTIONS. PLEASE READ CAREFULLY BEFORE INSTALLATION.

Rough in:

It is essential for the installation of the fluid 1.28 gpf (4.8 lpf) Two Piece Siphonic Toilet that the closet flange must be accurately set out from the finished wall as detailed in Fig. 1.

Working Water Pressure:

USA & Canada: Recommended working water pressure 20-80psi (140-550Kpa).

Closet Bowl Installation Procedure:

- 1- Position closet bolts, (not supplied), into closet flange, as detailed in Fig. 1, and secure with nuts by tightening with a wrench. Make sure that the two closet bolts point straight up, are positioned directly across from one another, and align with the holes in the base of the bowl.
- 2- Ensure that the area around the closet bowl is clear and free from building material.
- 3- Position and firmly place wax ring, (not supplied), onto the trapway, as detailed in Fig. 2.
- 4- Accurately align the closet bowl over the closet bolts and flange and lower into position as detailed in Fig. 3.
- 5- Install plastic base over the closet bolts, then secure closet bowl by hand tightening nuts and washers onto the closet bolts as detailed in Fig. 4. Apply an additional 1/2 turn with wrench for final installation. Do not over-tighten.
- 6- Ensure that each closet bolt does not extend more than 6 mm from the top of the nut, as shown in Fig. 5. (If the bolts are too long, cut to 6 mm). Cover the closet bolts with the supplied plastic caps.
- 7- It is recommended that a bead of silicone caulking is applied fully around base of the closet bowl, leaving 1-2" at the rear.
- 8- Remove any excess silicone caulking.

All measurements are subject to accepted manufacturing tolerance. The manufacturer reserves the right to change specifications at any time without giving prior notification. The product should be installed by a qualified plumber. Local authority, Water Board, and Building Regulations may apply to the installation of this product, and you should consult the appropriate bodies on these requirements. Failure to comply may invalidate the product warranty.

For further information, please visit our website www.sustainable-solutions.com

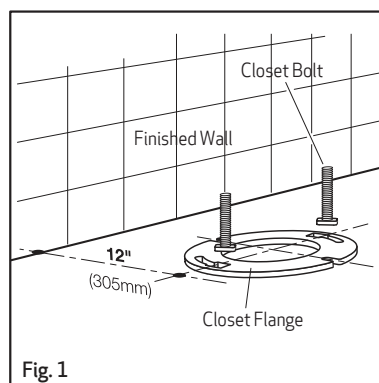
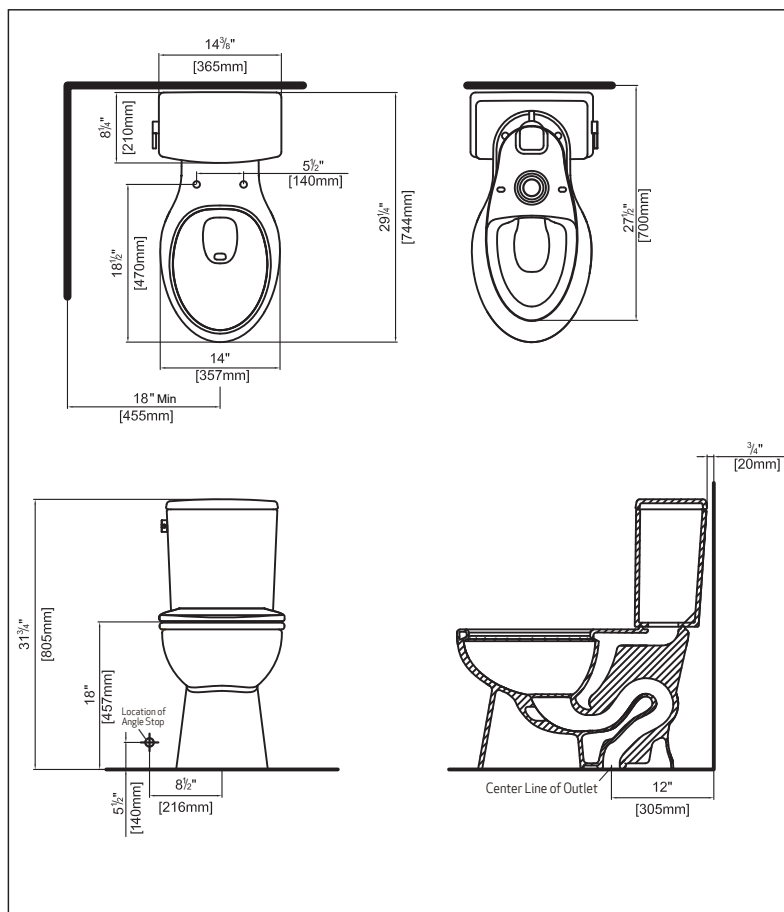

Fig. 1

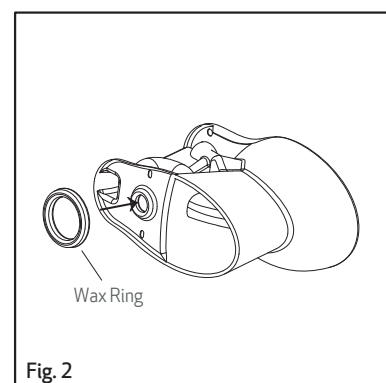

Fig. 2



Fig. 3

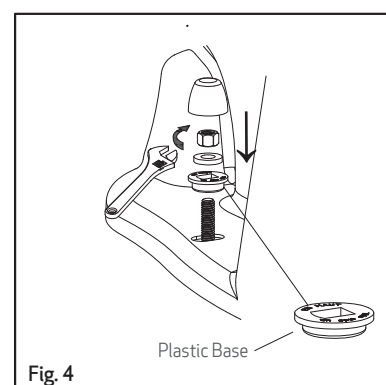

Fig. 4

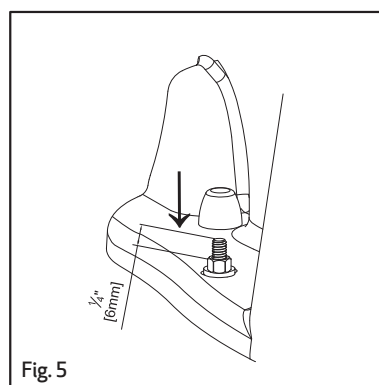

Fig. 5

fluid

Duo Single Flush High Efficiency Siphonic Toilet (HET)

Two Piece 1.28 gpf (4.8 lpf) Easy Height & Elongated Bowl and Tank with Side Lever Handle.

Bowl #301502W Tank #301548W / 301548W-R

Tank Installation Procedure:

- 1- Determine the type of water supply connection to be used. Braided supply lines can simply be attached to the inlet valve connection. If a 3/8" hard tube/pipe connection is being used, a tapered rubber seal and wing nut assembly is included.
- 2- Ensure that the enclosed foam seal is fitted onto the tail piece on the underside of the tank as detailed in Fig. 6.
- 3- Lower tank onto closet bowl, allowing the two tank fixing bolts protruding below the tank to fit through the corresponding holes in the bowl.
- 4- Fit the supplied plastic wing nuts onto the tank fixing bolts that are protruding through the bowl and gradually tighten the left and right wing nuts by hand to evenly secure tank to bowl.
- 5- Connect the water supply line and turn on the water supply as shown in Fig. 7.
- 6- Install the toilet seat according to the instructions included with the seat.
- 7- Fit the tank lid onto the top of tank.

Tank Spare Parts

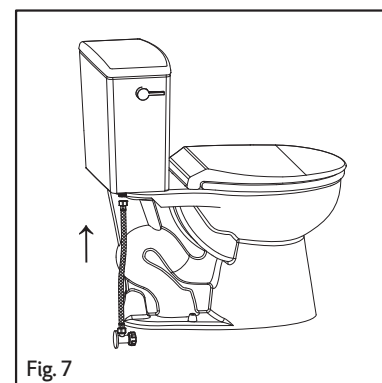
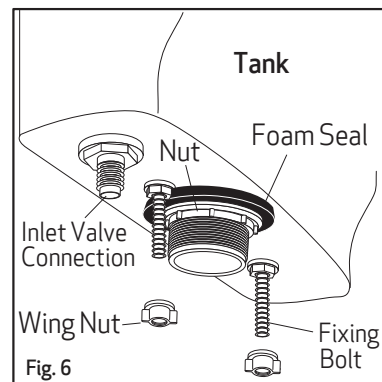

Inlet Valve Replacement Parts

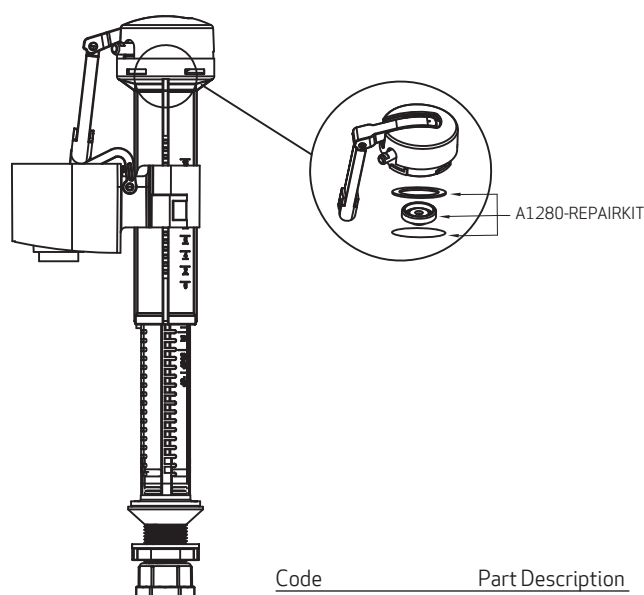

Code	Part Description
A1280-REPAIRKIT	Rubber Seal Kit
A1280	Inlet Valve

Outlet Valve Replacement Parts

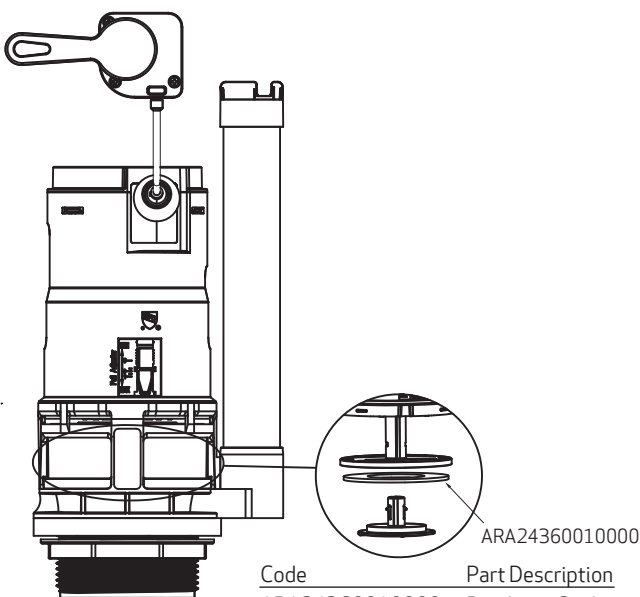

Code	Part Description
ARA24360010000	Diaphragm Seal
A2436	Outlet Valve
A2436060300-C	Left Hand Lever
A2436060400-C	Right Hand Lever

CLEANING INSTRUCTIONS FOR VITREOUS CHINA:

To preserve the glazed surface, this toilet should be cleaned only with a mild household detergent or warm soapy water. Do not use any abrasive cleaners or bleach in the tank or bowl as this can damage the glazing. Use of in tank cleaners or bleach tablets may void warranty.

For spare parts contact:

**Sustainable
Solutions**

Designed and Manufactured by Sustainable Solutions
Telephone: (604) 430.2020
Toll Free: (800) 460.7019
help@sustainable-solutions.com
<https://shop.sustainable-solutions.com/>
www.sustainable-solutions.com

