

## Wisdom Tub & 6" Shower Trim Kit

F284109TMB

### Specifications:

- Metal construction for durability and reliability
- Pressure balancing 2-way diverting system
- Max-temperature limit stop for added safety
- Integral stop check valves for easy maintenance
- Valve and trim packages are sold separately
- Requires the fluid F1002B pressure balancing valve, (sold separately and available with shut off in solder, PEX and PEX-W.)

### Components:

F1001TMB	.....	Cartridge Sleeve
FP6028341MB	.....	Wisdom Handle
FP6001035MB-2PS	.....	Cover Plate
FP6016008MB	.....	8" Shower Arm
FP6000350MB	.....	6" Shower Head
FP6098034MB	.....	Round Diverting Tub Spout



### Features:



Requires F1002B



Bubble Level



Integral Stops



Slip Fit Connection

Available in Matte Black

## Technical Drawing

F284109TMB

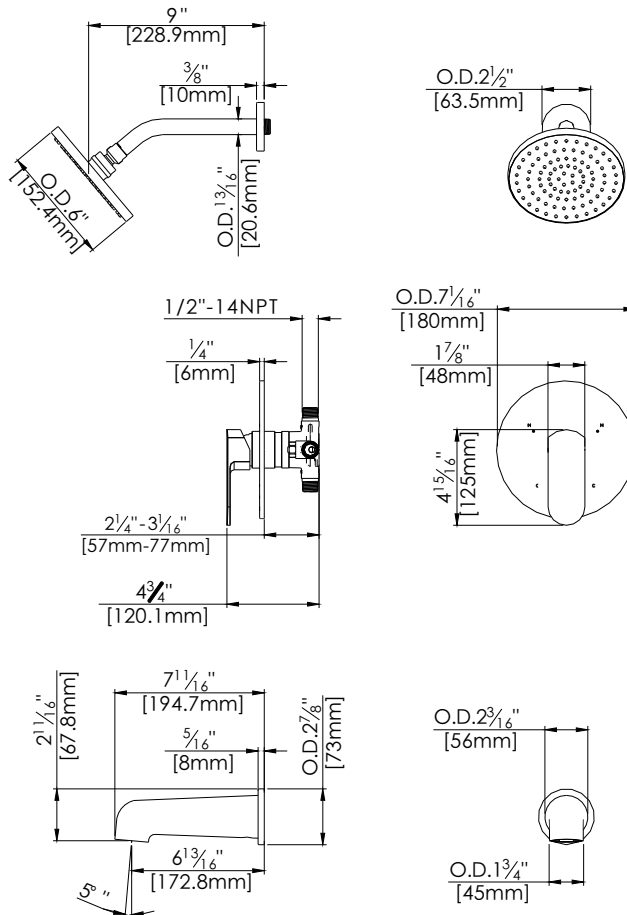

## Warranty:

Limited Lifetime Faucet Warranty  
against material and manufacturing  
defects for residential use.

2 Year Limited Warranty on all industrial,  
commercial and business applications.

## Codes and Standards:

ANSI/ASME A112.18.1, CSA  
B125.1, IAPMO / cUPC Listed, EPA  
Watersense Listed

## Flow Rate:

Shower Head 1.8 gpm @ 60 psig  
Tub Spout 4.5gpm @ 60 psig

Low Flow Alternative: Shower Head @  
1.5 gpm: **F284109TMB-15**