

## Citi 4" Shower Head Trim Kit

F241077TMB

### Specifications:

- ➔ Metal construction for durability and reliability
- ➔ Pressure balancing volume control (non-diverting)
- ➔ Max-temperature limit stop for added safety
- ➔ Integral stop check valves for easy maintenance
- ➔ Valve and trim packages are sold separately
- ➔ Requires the fluid F1001B pressure balancing valve, (sold separately and available with shut off in solder, PEX and PEX-W.)

### Components:

F1001TMB ..... Cartridge Sleeve  
 FP6024041MB ..... Citi Handle  
 FP6001035-1PB ..... Cover Plate  
 FP6016008MB ..... 8" Shower Arm  
 FP10120MB ..... 4" Shower Head



### Features:



Requires F1001B



Bubble Level



Integral Stops

Available in Matte Black



## Technical Drawing

F241077TMB

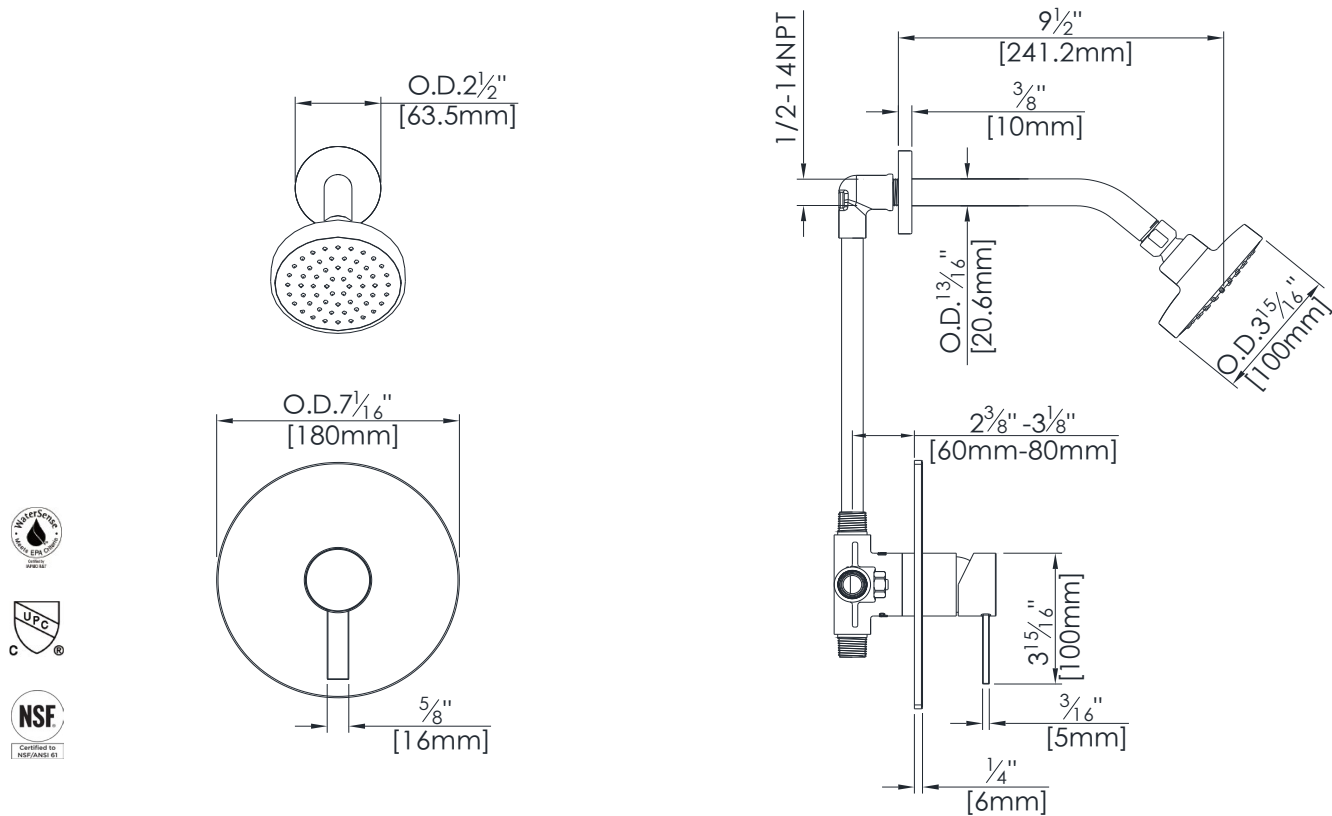

## Warranty:

Limited Lifetime Faucet Warranty against material and manufacturing defects for residential use.

2 Year Limited Warranty on all industrial, commercial and business applications.

## Codes and Standards:

ANSI/ASME A112.18.1, CSA B125.1, IAPMO/cUPC Listed, EPA WaterSense Listed

## Flow Rate:

Shower Head 1.8 gpm @ 60 psig

Low Flow Alternative: Shower Head @ 1.5 gpm: **F241077TMB-15**