

## Yaletown Tub, Rain Shower & Hand Shower on Slide Bar Trim Kit

F193224T

### Specifications:

- ➔ Metal construction for durability and reliability
- ➔ Pressure balancing volume control with 3-way, two handle diverting
- ➔ Maximum temperature limit stop for added safety
- ➔ Integral stop check valves for easy maintenance
- ➔ Valve and trim packages are sold separately
- ➔ Requires the fluid F1003B pressure balancing valve, (sold separately and available with shut off or **\*\*sharing** in solder, PEX and PEX-W, F1960 Expansion PEX.)

### Components:

F1001T .....	Cartridge Sleeve
FP6019041 .....	Cartridge Handle
FP801013 .....	Diverter Sleeve
FP605752 .....	Diverter Handle
FP6001143-3PB .....	Cover Plate
FP6002050 .....	8" Brass Showerhead
FP6007108 .....	16" Shower Arm
FP40120 .....	3 Function Hand Shower
FA802 .....	Slide Bar With Integral Outlet
FP6001006 .....	60" Shower Hose
FP6096035 .....	Square Tub Spout

**\*\*sharing available where allowed by code**

Kit with Alternate ADA Diverter Handle: **F193224T-AR**



### Features:

-  Requires F1003B
-  Bubble Level
-  Integral Stops
-  Slip fit Connection



Available in Polished Chrome (CP) and Brushed Nickel (BN)



## Technical Drawing

# F193224T

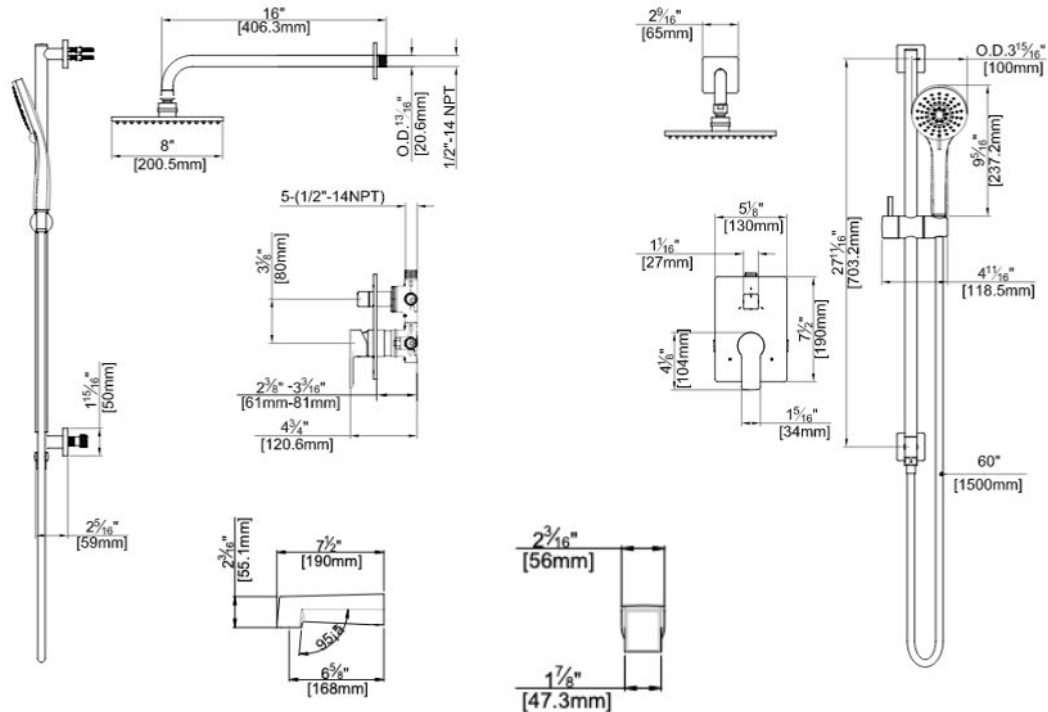

**Codes and Standards:** ANSI/ASME A112.18.1, CSA B125.1, IAPMO/cUPC Listed, EPA Watersense Listed

### Warranty:

Limited Lifetime Faucet Warranty against material and manufacturing defects for residential use.

2 Year Limited Warranty on all industrial, commercial and business applications.

### Kit Variations:

Kit with ADA diverter handle:

**F193224T-AR**

Kit with square style cover plate & diverter handle: **F193224T-S**

### Flow Rate:

Shower Head 1.8 gpm @ 60 psig

Hand Shower 1.8 gpm @ 60 psig

Tub Spout 4.5 gpm @ 60 psig

Low Flow Alternative: Hand Shower @ 1.5 gpm: **F193224T-15**