

Citi Tub & 6" Shower Head Trim, (Two handle)

F242002T

Specifications:

- Metal construction for durability and reliability
- Pressure balancing volume control with 2-way diverter with shut off
- Maximum temperature limit stop for added safety
- Integral stop check valves for easy maintenance
- Valve and trim packages are sold separately
- Requires the fluid F1012B pressure balancing valve, (sold separately and available in solder, PEX and PEX-W.)

Components:

F1001T	Sleeve Tube and Cap
FP6024041	Citi Handle
FP801013	Diverter Sleeve
FP605652	Diverter Handle
FP6001142-2PB	Round Cover Plate
FP6000350	6" Round Shower Head
FP6016008	8" Shower Arm
FP6057034	8" Pipe Tub Spout

Kit with Alternate Handle: **F242002T-AR**



Features:



Requires F1012B



Bubble Level



Integral Stops



Speed Connect

Polished Chrome (CP), Brushed Nickel (BN) and Matte Black (MB)

Technical Drawing

F242002T

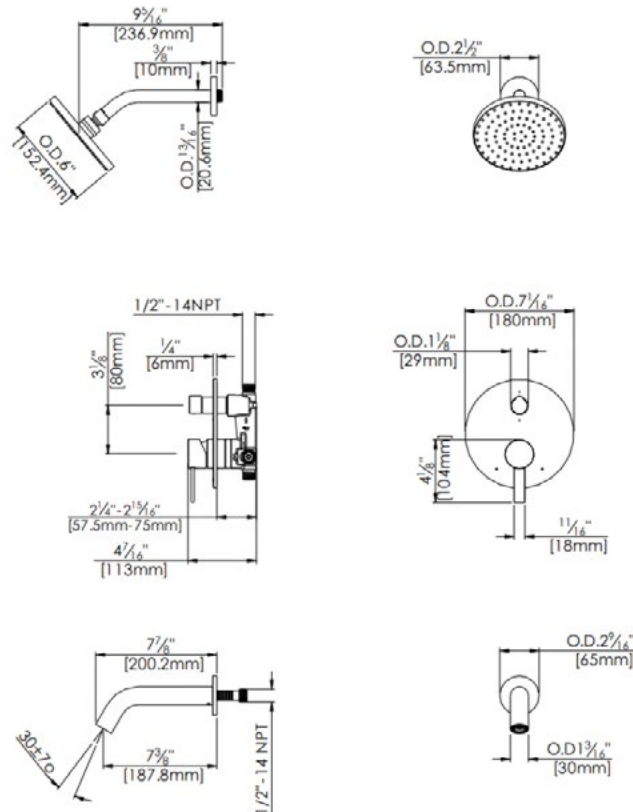

Codes and Standards: ANSI/ASME A112.18.1, CSA B125.1, IAPMO / cUPC Listed, EPA Watersense Listed

Warranty:

Limited Lifetime Faucet Warranty against material and manufacturing defects for residential use.

2 Year Limited Warranty on all industrial, commercial and business applications.

Kit Variations:

Kit with round ADA diverter handle: [F242002T-AR](#)



Kit with square style cover plate & diverter handle: [F242025T-S](#)

Flow Rate:

Shower Head 1.8 gpm @ 60 psig
Tub Spout 4.5 gpm @ 60 psig

Low Flow Alternative: Shower Head
@ 1.5 gpm: [F242002T-15](#)
@ 1.0 gpm: [F242002T-10](#)