

## Specifications:

- Metal construction for durability and reliability
- Non-Diverting pressure balancing volume control
- Max-temperature limit stop for added safety
- Integral stop check valves for easy maintenance
- Valve and trim packages are sold separately
- Requires the fluid F1001B pressure balancing valve, (sold separately and available with shut off in solder, PEX and PEX-W.)

## Components:

F1001T .....	Cartridge Sleeve
FP6021041 .....	Jovian Handle
FP6001033-1PB .....	Cover Plate
FP6004048 .....	Square Hand Shower
FA104 .....	Slide Bar
FP6001047 .....	Wall Outlet
FP6001006 .....	60" Shower Hose

## Features:

-  Requires F1001B
-  Bubble Level
-  Integral Stops
-  Speed Connect

## Jovian Square Hand Shower On Slide Bar Trim Kit

F211253T



Available in Polished Chrome (CP) and Brushed Nickel (BN)

## Technical Drawing

F211253T

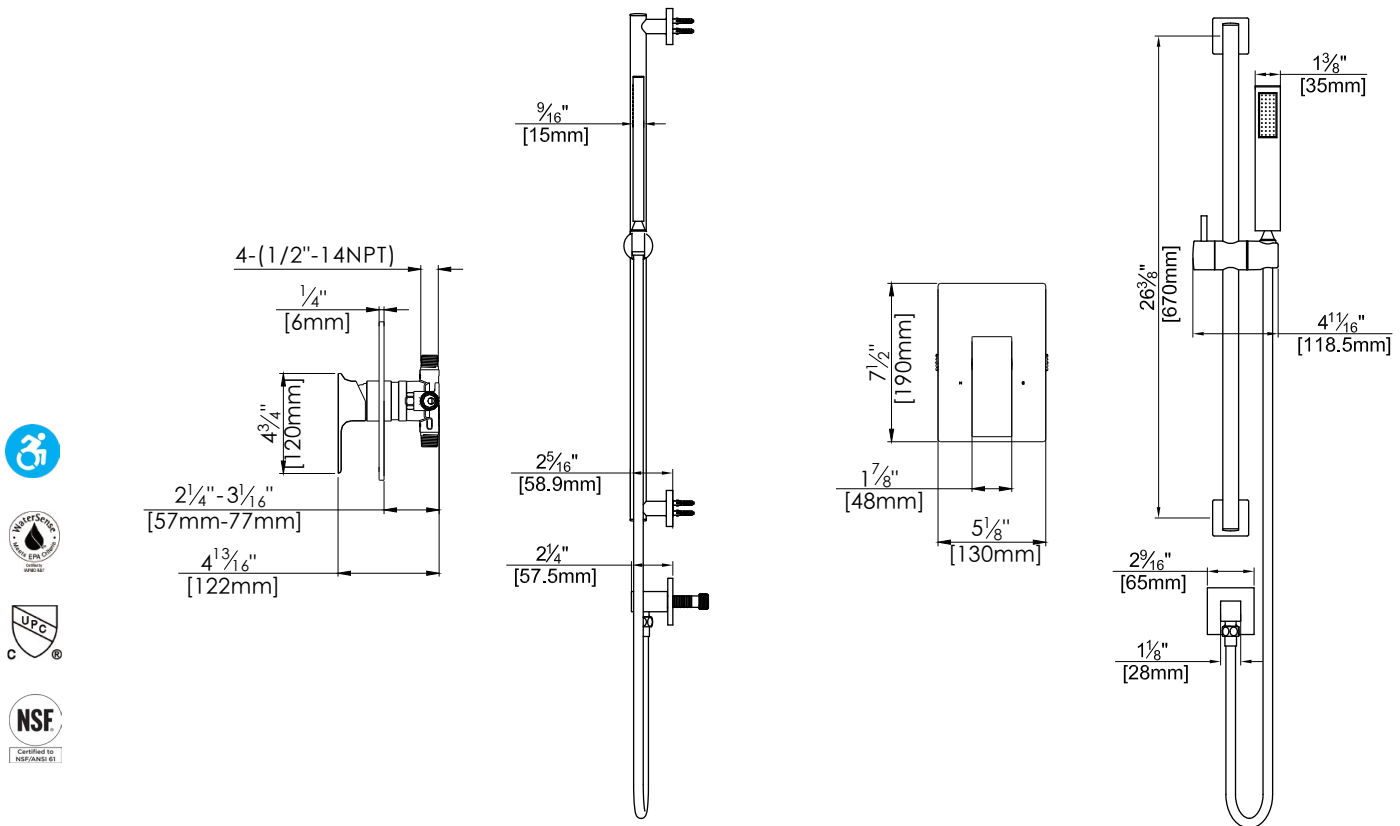

## Warranty:

Limited Lifetime Faucet Warranty against material and manufacturing defects for residential use.

2 Year Limited Warranty on all industrial, commercial and business applications.

## Codes and Standards:

ANSI/ASME A112.18.1, CSA B125.1, IAPMO/cUPC Listed, EPA WaterSense Listed

## Flow Rate:

Hand Shower 1.8 gpm @ 60 psig

Low Flow Alternative: Hand Shower @ 1.5 gpm: **F211253T-15**