

Specifications:

- Metal construction for durability and reliability
- Pressure balancing volume control with 2-way two handle diverting
- Max-temperature limit stop for added safety
- Integral stop check valves for easy maintenance
- Valve and trim packages are sold separately
- Requires the fluid F1012B pressure balancing valve, (sold separately and available with shut off in solder, PEX and PEX-W.)

Components:

F1001T.....	Cartridge Sleeve
FP6019041	Yaletown Handle
FP801013.....	Diverter Sleeve
FP605752.....	Diverter Handle
FP6001143-2PB.....	Square Cover Plate
FP6007108.....	16" Shower Arm
FP6001050.....	8" Brass Shower Head
FP6096035	Square Tub Spout

Yaletown Square 8" Shower Head & Hand Shower Trim Kit

F192262T



Features:

-  Requires F1012B
-  Bubble Level
-  Integral Stops
-  Slip fit Connection

Available in Polished Chrome (CP) and Brushed Nickel (BN)

Technical Drawing

F192262T

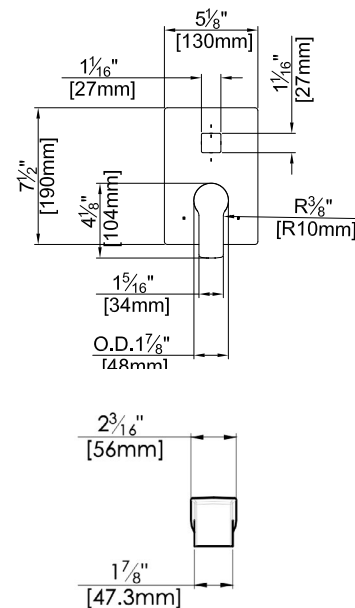
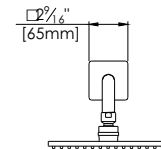
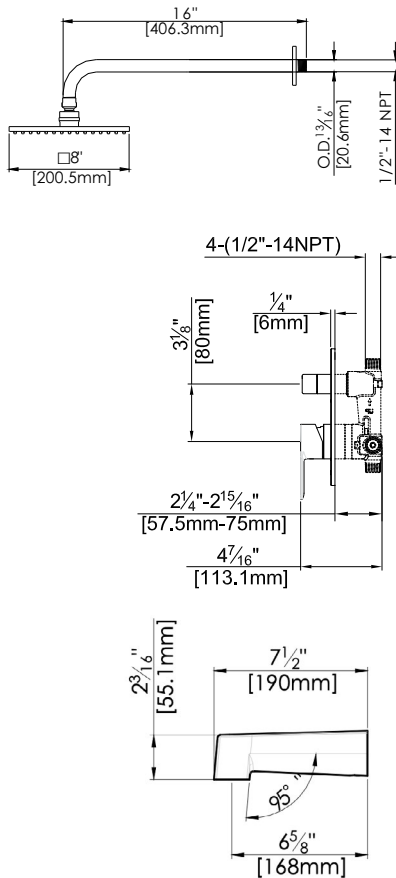

Codes and Standards: ANSI/ASME A112.18.1, CSA B125.1, IAPMO / cUPC Listed, EPA Watersense Listed

Warranty:

Limited Lifetime Faucet Warranty against material and manufacturing defects for residential use.

2 Year Limited Warranty on all industrial, commercial and business applications.

Kit Variations:



Kit with alternate ADA diverter handle: **F192262T-AS**

Flow Rate:

Shower Head 1.8 gpm @ 60 psig
Tub Spout 4.5 gpm @ 60 psig