

Specifications:

- Metal construction for durability and reliability
- Pressure balancing volume control
- Maximum temperature limit stop for added safety
- Integral stop check valves for easy maintenance
- Valve and trim packages are sold separately
- Requires the fluid F1001B pressure balancing valve, (sold separately and available in solder, PEX and PEX-W.)
- ADA Compliant

Components:

F1001T Cartridge Sleeve
 FP6024041 Citi Handle
 FP6001035-1PB Round Cover Plate
 FP40120 3 Function Hand Shower*
 FA802 Slide Bar with Integral Outlet
 FP6001006 60" Shower Hose*

* Matte black versions feature the FP6001007MB Shower Hose & FP40130MB 3-Function Hand Shower

Features:

-  Requires F1001B
-  Bubble Level
-  Integral Stops
-  Speed Connect

Citi 3 function Hand Shower Trim Kit with FA802 Slide Bar

F241019T

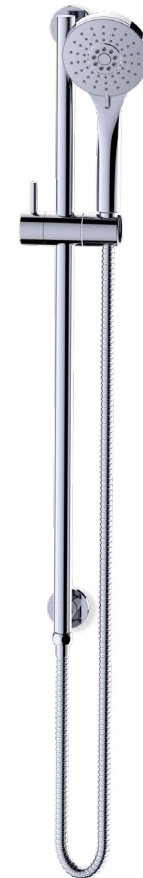

Polished Chrome (CP), Brushed Nickel (BN) and Matte Black (MB)

Technical Drawing

F241019T

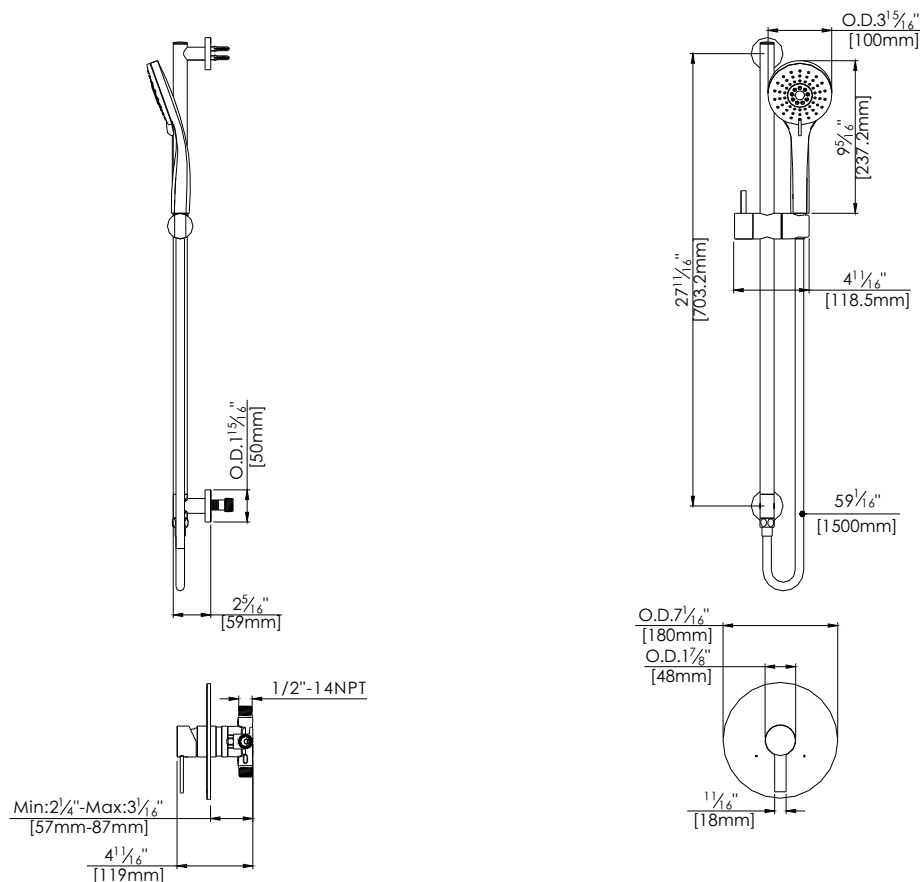

Codes and Standards: ANSI/ASME A112.18.1, CSA B125.1, IAPMO / cUPC Listed, EPA Watersense Listed

Warranty:

Limited Lifetime Faucet Warranty against material and manufacturing defects for residential use.

2 Year Limited Warranty on all industrial, commercial and business applications.

Kit Variations:

Kit with square style cover plate & diverter handle: **F241019T-S**

Flow Rate:

Hand Shower 1.8 gpm @ 60 psig

Low Flow Alternative: Hand Shower @ 1.5 gpm: **F241019T-15**