

## Specifications:

- Metal construction for durability and reliability
- Pressure balancing with 2-way, single handle diverting and temperature control
- Max-temperature limit stop for added safety
- Integral stop check valves for easy maintenance
- Valve and trim packages are sold separately
- Requires the fluid F1002B pressure balancing valve, (sold separately and available in solder, PEX and PEX-W.)

## Components:

F1001T .....	Sleeve tube and cap
FP6018041 .....	Utopia Handle
FP6001035-2PS .....	Round Cover Plate
FP6016008 .....	8" Shower Arm
FP6000350 .....	6" Shower Head
FP6057034 .....	PipeTub Spout

## Features:

-  Requires F1002b
-  Bubble Level
-  Integral Stops
-  Speed Connect

## Utopia Tub & 6" Shower Trim Kit (Single Handle)

F184102T



Available in Polished Chrome (CP) and Brushed Nickel (BN)

## Technical Drawing

F184102T

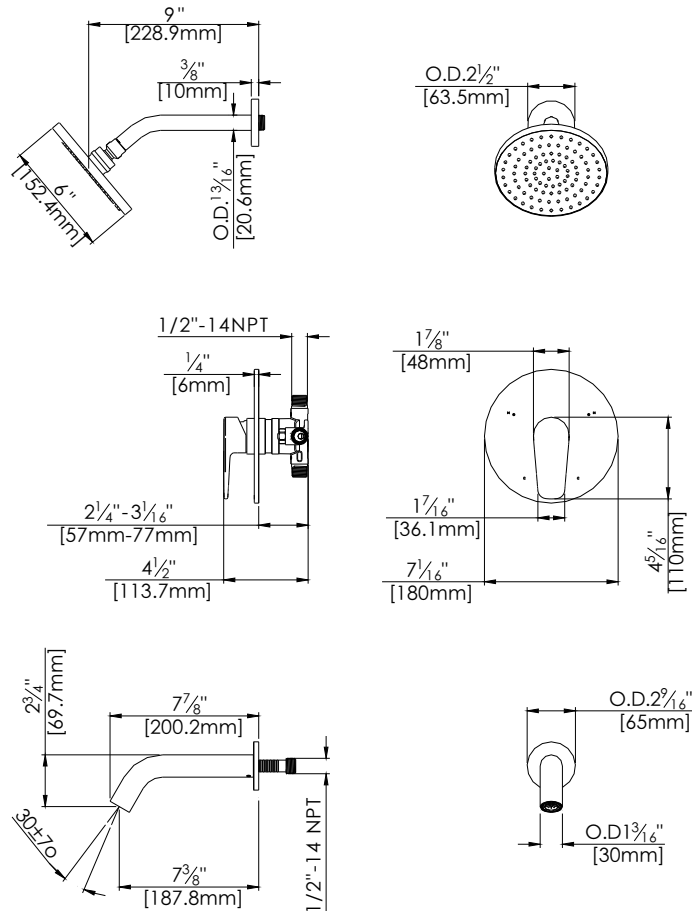

## Warranty:

Limited Lifetime Faucet Warranty  
against material and manufacturing  
defects for residential use.

2 Year Limited Warranty on all industrial,  
commercial and business applications.

## Codes and Standards:

ANSI/ASME A112.18.1

CSA B125.1

IAPMO / cUPC Listed

## Flow Rate:

Shower Head 1.8 gpm @ 60 psig

Tub Spout 4.5 gpm @ 60 psig

Low Flow Alternative: Shower Head  
@ 1.5 gpm: **F184108T-15**