

Utopia Tub & 5 Function Shower Trim Kit, (Single Handle)

F184104T

Specifications:

- Metal construction for durability and reliability
- Pressure balancing with 2-way, single handle diverting and temperature control
- Max-temperature limit stop for added safety
- Integral stop check valves for easy maintenance
- Valve and trim packages are sold separately
- Requires the fluid F1002B pressure balancing valve, (sold separately and available in solder, PEX and PEX-W.)

Components:

F1001T	Sleeve Tube and Cap
FP6018041	Utopia Handle
FP6001035-2PS	Round Cover Plate
FP20100	5 Function Shower Head
FP6016008	8" Shower Arm
FP6057034	Pipe Tub Spout



Features:



Requires F1002B



Bubble Level



Integral Stops



Speed Connect

Available in Polished Chrome (CP) and Brushed Nickel (BN)

Technical Drawing

F184104T

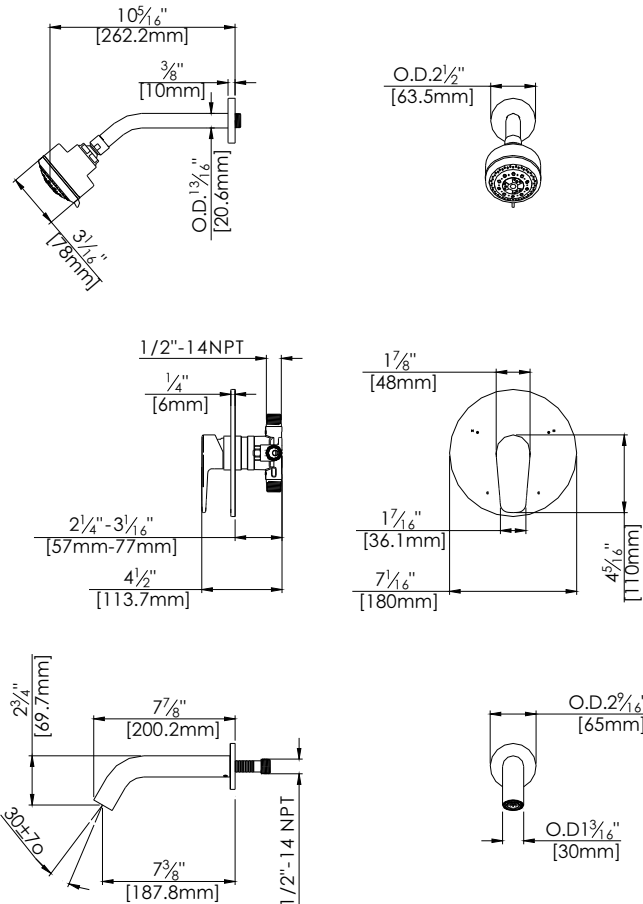

Warranty:

Limited Lifetime Faucet Warranty
against material and manufacturing
defects for residential use.

2 Year Limited Warranty on all industrial,
commercial and business applications.

Codes and Standards:

ANSI/ASME A112.18.1

CSA B125.1

IAPMO / cUPC Listed

Flow Rate:

Shower Head 1.8 gpm @ 60 psig

Tub Spout 4.5 gpm @ 60 psig

Low Flow Alternative: Shower Head
@ 1.5 gpm: **F184104T-15**