

Oceanside 5 Function Shower Head & Tub Spout Trim Kit

F232015T

Specifications:

- Metal construction for durability and reliability
- Pressure balancing volume control with 2-way diverter
- Maximum temperature limit stop for added safety
- Integral stop check valves for easy maintenance
- Valve and trim packages are sold separately
- Requires the fluid F1012B pressure balancing valve, (sold separately and available in solder, PEX and PEX-W, F1960 Expansion PEX.)

Components:

F1001T	Sleeve Tube and Cap
FP6023041	Oceanside Handle
FP801013	Diverter Sleeve
FP605752	Diverter Handle
FP6001143-2PB	Square Cover Plate
FP20100	5 Function Shower Head
FP6027008	8" Shower Arm
FP6054034	Sloped Tub Spout



Kit with Alternate ADA Diverter Handle: **F232015T-AS**



Features:

- | | |
|--|---|
|  Requires F1012B |  Bubble Level |
|  Integral Stops |  Speed Connect |

Polished Chrome (CP), Brushed Nickel (BN)

Technical Drawing

F232015T

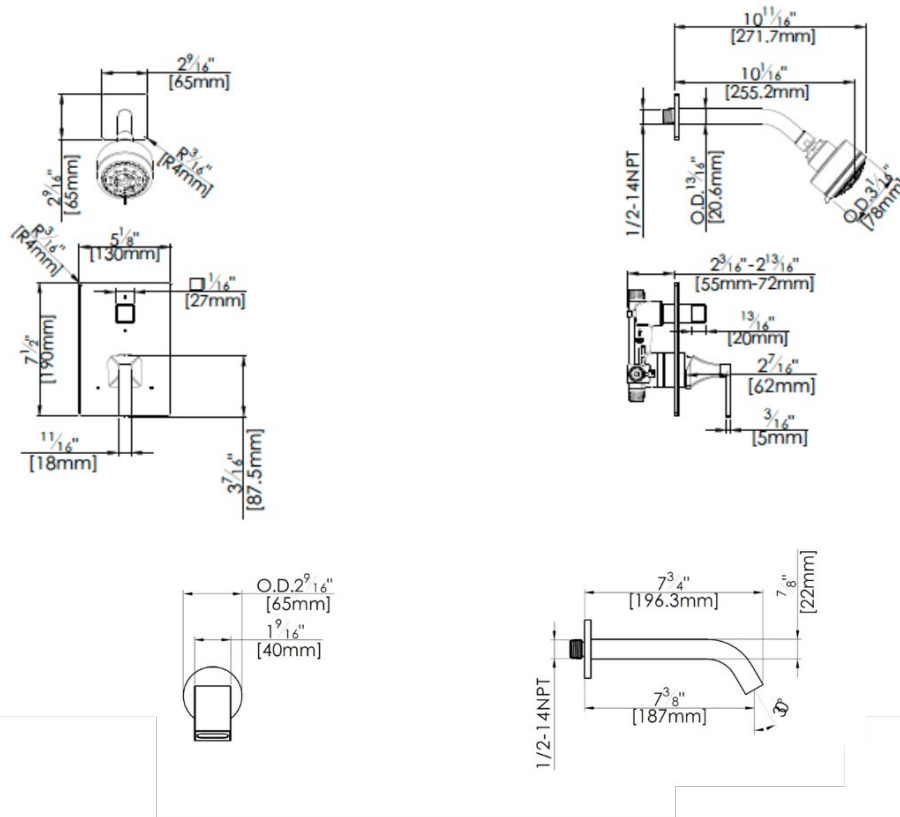

Codes and Standards: ANSI/ASME A112.18.1, CSA B125.1, IAPMO / cUPC Listed, EPA Watersense Listed

Warranty:

Limited Lifetime Faucet Warranty against material and manufacturing defects for residential use.

2 Year Limited Warranty on all industrial, commercial and business applications.

Kit Variations:

Kit with ADA diverter handle:
[F232015T-AS](#)

Flow Rate:

Shower Head 1.8 gpm @ 60 psig
Tub Spout 1.8 gpm @ 60 psig

Low Flow Alternative: Shower Head
@ 1.5 gpm: [F232015T-15](#)