

Limited Lifetime Faucet Warranty

Fluid™ warrants its faucets to be free from defects in material and workmanship for as long as the original consumer purchaser owns his or her home.* This warranty applies only in original installation location. If a defect is found in normal residential use, Fluid™ will, at its election, repair, provide a replacement part or product, or make an appropriate adjustment. Fluid™ reserves the right to examine the product in question and its installation prior to replacement. This warranty is limited to replacement of defective parts only. Damage to a product caused by accident, improper installation, misuse, or abuse is not covered by this warranty. Improper care and cleaning will void the warranty.** Replacement parts can be obtained from your local dealer or directly from the Fluid™ warehouse. Dated proof of purchase must accompany all warranty claims. This warranty applies only to Fluid™ faucets installed in the United States of America, Canada or Mexico (North America).

Fluid™ recommends using a certified plumber for faucet installation and repair. Incidental and consequential damages, labor charges, repair or replacement costs are expressly excluded. In no event shall the liability of Fluid™ exceed the purchase price of the faucet. Some states and provinces do not allow the exclusion or limitation of incidental or consequential damages, so the above limitation may not apply to you. This warranty gives you specific legal rights which vary from state/province to state/province. If you find any such problem with your product, please immediately contact your nearest Fluid™ dealer or sales representative.

Need Help?

For additional assistance or service call

Toll Free: 1 800 460 7019

Tel: 1 604 430 2020

Fax: 1 604 430 5050

www.fluidfaucets.com

* Two year warranty on commercial applications.

** Never use cleaners containing abrasive cleansers, ammonia, bleach, acids, waxes, alcohol, solvents or other products not recommended for surface finishes. This will void the warranty.

This faucet meets or exceeds the following standards:

ASME A112.18.1 / CSA B125.1 / NSF61-9 / AB1953 / EPA WaterSense

This product has been tested and certified by IAPMO.

fluid |

SSI
SUSTAINABLE
SOLUTIONS
INTERNATIONAL

Installation Instructions for Dual Handle Lavatory Faucet



IAPMO LISTED



SSI
SUSTAINABLE
SOLUTIONS
INTERNATIONAL

Sustainable Solutions International
Phone: 1 800 460 7019
www.SustainableSolutions.com

Dual Handle Lavatory Faucet/2013/12

Please Keep This Manual For Future Reference

Tools Required for Installation



Allen Wrench



Adjustable Wrench



Teflon Tape



Screw Driver

NOTE: Handle sets (#24) come pre-assembled and are inserted as a unit from above the mounting deck. There is no need to take off handle (#10), and escutcheon (#11) for installation.

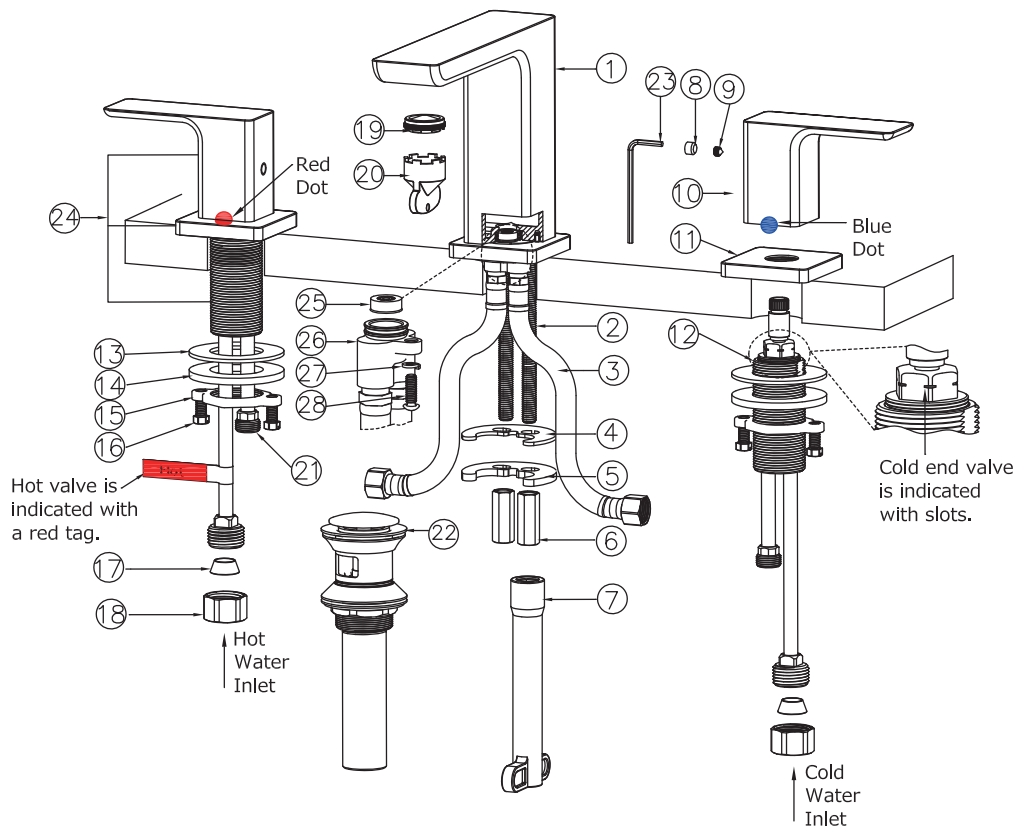

Specifications:

Max flow	1.5 gpm or 5.7L/min at 60 psig
Flow pressure	15-72.5 psi
Max pressure	120 psi
Max temperature	176 °F or 80 °C
Inlet connection	1/2" NPT and 3/8" Riser

Installation Instructions

1. Shut off cold and hot water supply.
 2. Faucet hole should be minimum 1-1/4" (32mm) and maximum 1-7/16" (36mm) in diameter.
 3. From above the deck, insert spout (#1) into the center hole.
 4. From underneath the deck, slide gasket (#4) and plate (#5) over mounting rods (#2). Screw and tighten mounting nuts (#6) by using a supplied wrench tool.
 5. Remove nuts (#15), washers (#14) and gaskets (#13) from valve sets (#12).
 6. From above the deck, insert pre-assembled handle sets (#24) into hole and make sure red or blue dot is facing you OR the lever handle points outward when in OFF position. HOT valve body tagged with a red label should be on the left side, and COLD valve body indicated with slots which can be seen after removing handle (#10) on the right side.
 7. From underneath the deck, slide gaskets (#13) and washers (#14) onto valve sets (#12), then hand tighten nuts (#15). Finally tighten locking screws (#16) with a screw driver.
- Note:** To adjust handle, from underneath the deck, untighten locking screws (#16) and loosen nut (#15). From above the deck, adjust escutcheon (#11) after turning handle (#10) to point outward when in OFF position. Make sure the gap between
- escutcheon (#11) and handle (#10) is kept at minimum while maintaining smooth handle movement.
8. Once handle set (#24) is properly set in position, carefully peel off red and blue dot off from handle.
- Note:** Red and blue dot is used to prevent any possible movement between handle (#10) and escutcheon (#11) during the transportation and the installation while maintaining lever handle always pointing outward when in OFF position.
9. Connect SST flexible hose (#3) to valve outlet (#21).
- Note:** Make sure SST flexible hoses (#3) are free of kinks when they're connected to valve outlet (#21).
10. Connect valves (#12) to 1/2" NPT connectors or 3/8" (12.7mm) OD risers (not included) with supplied coupling nuts (#18) and washers (#17). Right hand valve is for cold water and left valve is for hot water supply.
 11. Please follow enclosed instruction for push type drain (#22) installation, if drain comes with this package.



Note: Vandal resistant tilting aerator features water saving technology (1.5gpm) in some faucet models, swivel flow direction adjustment by simply pushing the inside of the aerator to direct stream.

Care & Maintenance Instructions

SSI products are designed and engineered under strict quality standards. Regular and proper care of our products will ensure years of trouble-free service.

For Aerator:

Regularly remove aerator (#19) with enclosed service key (#20) and wash with clean running water and ensure that any trapped debris has been removed.

For Cartridge:

Remove mounting nut (#15), plate (#14) and gasket (#13) and pull up handle set (#24). Remove handle (#10) by pulling out silicon plug (#8) with a small needle tool and loosening set screw (#9) with an Allen wrench (#23). Unscrew escutcheon

(#11) off from valve set. Use an adjustable wrench to loosen cartridge (#12). Ensure cartridge is clean and free of blockages. Replace it if damaged.

For Flow Restrictor:

Remove connector (#26) by loosening screw (#28) with a screw driver. Use a small hooked tool to remove flow restrictor (#25). Ensure flow restrictor (#25) is clean and free of blockages.

For Surface Finish:

To clean, use a soft and damp cloth with warm soapy water followed by rinsing with clean water and drying with a soft cloth. Do not use abrasive or harsh cleaners as they may result in finish damage.