

Limited Lifetime Faucet Warranty

Fluid[™] warrants its faucets to be free from defects in material and workmanship for as long as the original consumer purchaser owns his or her home.* This warranty applies only in original installation location. If a defect is found in normal residential use, Fluid[™] will, at its election, repair, provide a replacement part or product, or make an appropriate adjustment. Fluid[™] reserves the right to examine the product in question and its installation prior to replacement. This warranty is limited to replacement of defective parts only. Damage to a product caused by accident, improper installation, misuse, or abuse is not covered by this warranty. Improper care and cleaning will void the warranty.** Replacement parts can be obtained from your local dealer or directly from the Fluid[™] warehouse. Dated proof of purchase must accompany all warranty claims. This warranty applies only to Fluid[™] faucets installed in the United States of America, Canada or Mexico (North America).

Fluid[™] recommends using a certified plumber for faucet installation and repair. Incidental and consequential damages, labor charges, repair or replacement costs are expressly excluded. In no event shall the liability of Fluid[™] exceed the purchase price of the faucet. Some states and provinces do not allow the exclusion or limitation of incidental or consequential damages, so the above limitation may not apply to you. This warranty gives you specific legal rights which vary from state/province to state/province. If you find any such problem with your product, please immediately contact your nearest Fluid[™] dealer or sales representative.

Need Help?

For additional assistance or service call
Toll Free: 1 800 460 7019
Fax: 1 604 430 5050
www.fluidfaucets.com

* One year warranty on commercial applications.

** Never use cleaners containing abrasive cleansers, ammonia, bleach, acids, waxes, alcohol, solvents or other products not recommended for surface finishes. This will void the warranty.

This faucet meets or exceeds the following standards:

ASME A112.18.1 / CSA B125.1 / NSF61-9

This product has been tested and certified by IAPMO.

fluid |

SSI[™]
SUSTAINABLE
SOLUTIONS
INTERNATIONAL

Installation Instructions for Dual Lever Lavatory Faucet

Dual Lever Lavatory Faucet/2008/10 | Ion Branding + Design



IAPMO LISTED



SSI[™]
SUSTAINABLE
SOLUTIONS
INTERNATIONAL

Sustainable Solutions International
Phone: 1 800 460 7019
www.SustainableSolutions.com

Please Keep This Manual For Future Reference

Tools Required for Installation

-  **Allen Wrench**
-  **Teflon Tape**
-  **Adjustable Wrench**

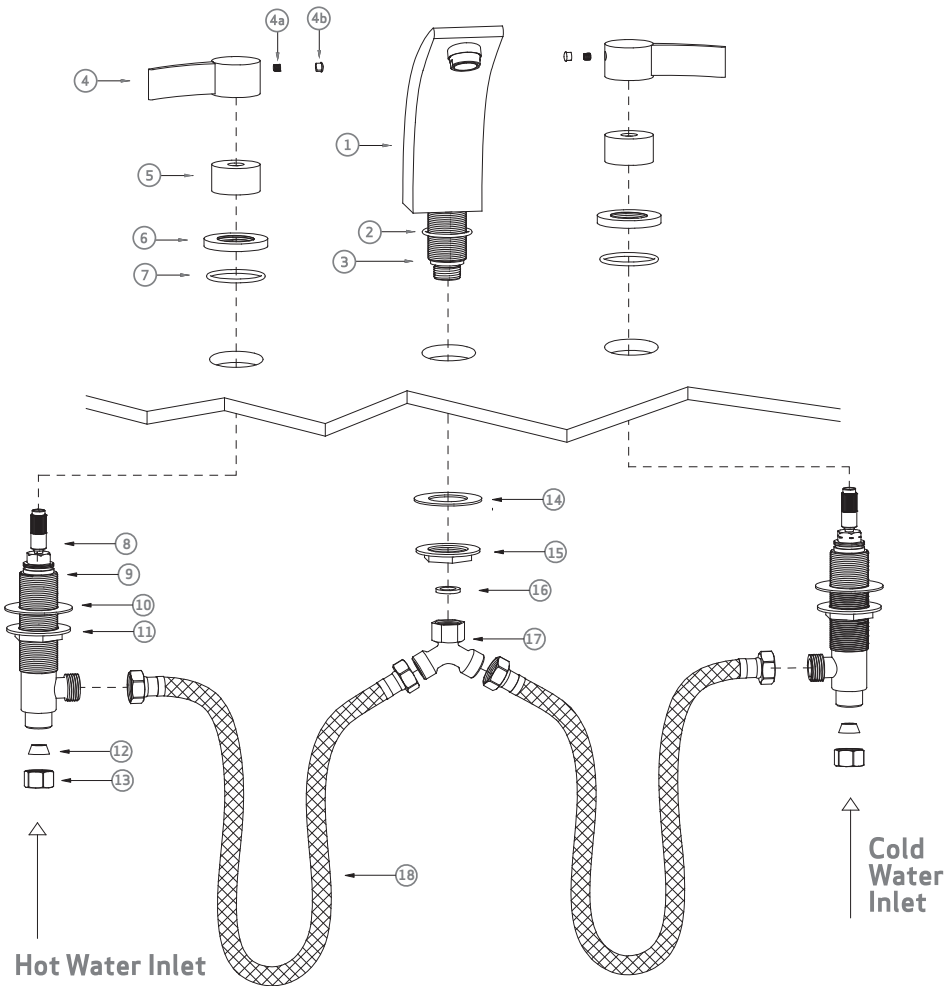

Installation Instructions

1. Shut off cold and hot water supply.
 2. Place the rubber seal washer (#2) at the base of the faucet body (#1) by sliding it over the spout shank (#3).
 3. Insert the spout shank (#3) into the center hole on the basin from above.
 4. Place the faucet body (#1) in position on the basin.
 5. From the underside of the basin, with the rubber mounting washer (#14) on the spout shank (#3), screw and tighten the mounting nut (#15) by using an adjustable wrench.
 6. Screw and tighten the 3 way connector (#17) with the rubber washer (#16) to the thread end of spout shank (#3).
 7. Since the handle (#4) was pre-installed at the factory, it is necessary to remove the handle (#4) from the valve stem (#8) by pulling out the decorative caps (#4b) and using an Allen wrench to loosen the set screw (#4a), then remove the escutcheon (#6) with the rubber seal washer (#7).
 8. Carefully insert the valve bodies (#9) in both remaining faucet holes from the underside of the basin. Make sure the "HOT" tagged valve body is on the left side and both valve outlets face the faucet body (#1).
 9. Adjust the rubber mounting washer (#10) and the nut (#11) while screwing the escutcheon (#6) with the rubber seal washer (#7) onto the valve body (#9). Tighten the mounting nut (#11) by using an adjustable wrench.
 10. Attach the hot/red handle and the cold/blue handle to the valve stem (#8) by tightening the set screw (#4a) with an Allen wrench, then assembling the decorative cap (#4b).
 11. Connect the stainless steel flexible hose (#18) to the 3 way connector (#17) and the outlet of the valve body (#9). Use Teflon tape.
 12. Connect the hot water supply line to the inlet of the red tagged/left valve body, and connect the cold water supply line to the inlet of the right valve body.
- Note: For 3/8" copper tubing connection, use a supply nut (#13) with rubber seal (#12).

Care & Maintenance Instructions

SSI products are designed and engineered under strict quality standards. Regular and proper care of our products will ensure years of trouble-free service.

For Aerator:
Regularly remove and wash the aerator with clean running water and ensure that any trapped debris has been removed.

For Surface Finish:
To clean, use a soft and damp cloth with warm soapy water followed by rinsing with clean water and drying with a soft cloth. Do not use abrasive or harsh cleaners as they may result in finish damage.